

GAUNTLET™

Operators Manual

Complete with Illustrated Parts Lists

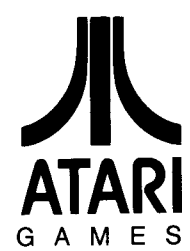
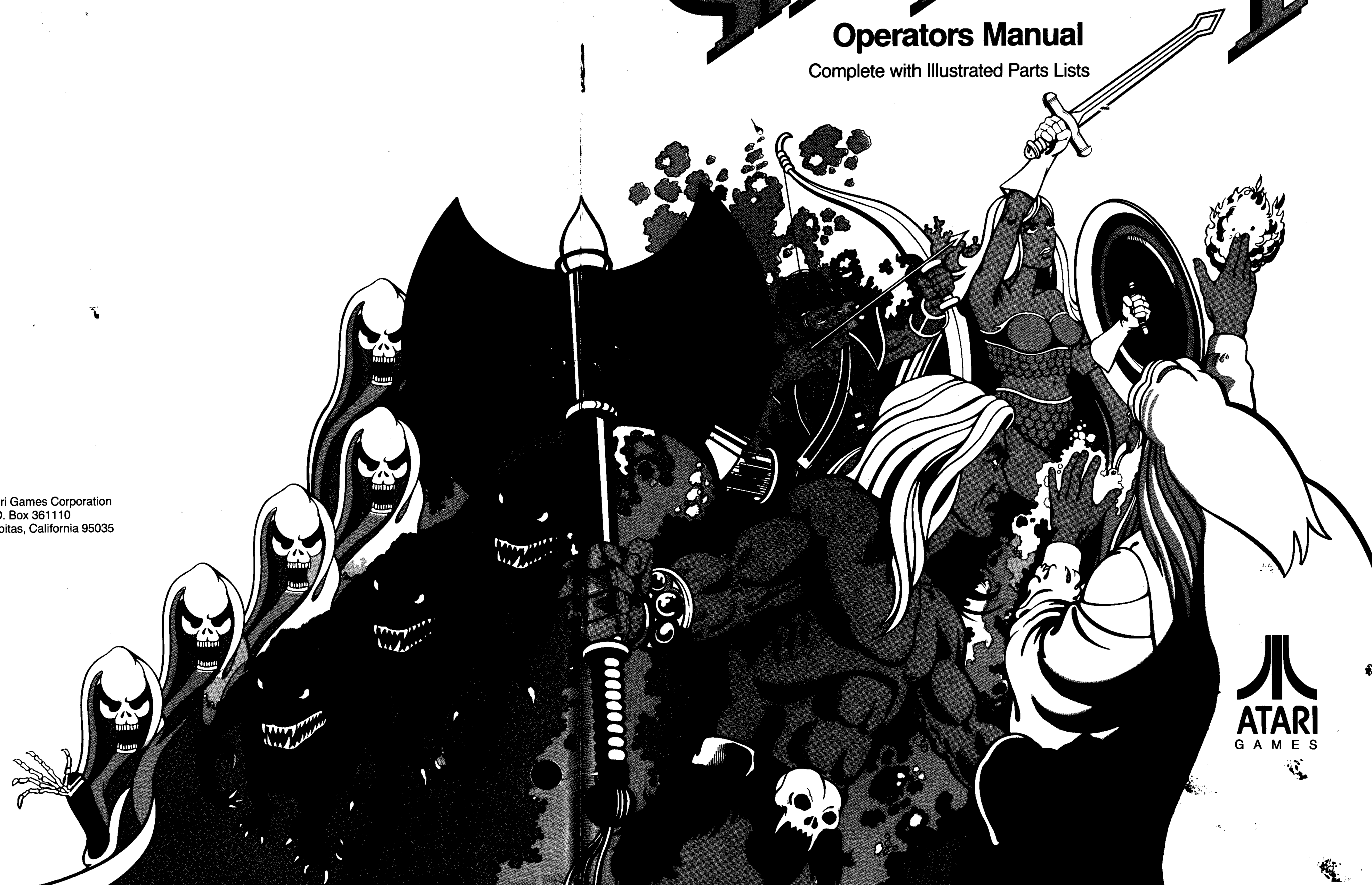

Atari Games Corporation
P.O. Box 361110
Milpitas, California 95035



Gauntlet™ Operators Manual
with Illustrated Parts Lists

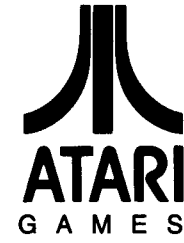

Notice Regarding Non-ATARI Parts

▲ WARNING ▲

Use of non-ATARI® parts or modifications of any ATARI game circuitry may adversely affect the safety of your game, and may cause injury to you and your players.

First Fold

Attach
Necessary
Postage

Atari Games Corporation
Attn: Customer Service
Tipperary Town, Ireland

Second Fold

From: _____

You may void the game warranty (printed on the inside back cover of this manual) if you do any of the following:

- Substitute non-ATARI parts in the game.
- Modify or alter any circuits in the game by using kits or parts *not* supplied by Atari Games Corporation.

NOTE

This equipment generates, uses, and can radiate radio frequency energy and if not installed and used in accordance with the instruction manual, may cause interference to radio communications. It has been tested and found to comply with the limits for a Class A computing device pursuant to Subpart J of Part 15 of Federal Communications Commission (FCC) Rules, which are designed to provide reasonable protection against such interference when operated in a commercial environment. Operation of this equipment in a residential area or modification to this equipment is likely to cause interference in which case the user, at his own expense, will be required to take whatever measures may be required to correct the interference. If you suspect interference from an ATARI® game at your location, check the following:

- All green ground wires in the game are properly connected as shown in the game wiring diagram.
- The power cord is properly plugged into a grounded three-wire outlet.

If you are still unable to solve the interference problem, please contact Customer Service at Atari Games Corporation. See the inside front cover of this manual for service in your area.

List of Illustrations

| | | |
|-------------|---|------|
| Figure 1-1 | Game Overview | 1-3 |
| Figure 1-2 | Control Panel Installation..... | 1-5 |
| Figure 1-3 | Control and Switch Locations..... | 1-6 |
| Figure 3-1 | RAM Test Fails..... | 3-2 |
| Figure 3-2 | ROM Test Fails | 3-2 |
| Figure 3-3 | Switch Test | 3-3 |
| Figure 3-4 | Coin Options | 3-3 |
| Figure 3-5 | Game Options | 3-4 |
| Figure 3-6 | Statistics | 3-5 |
| Figure 3-7 | Histograms..... | 3-5 |
| Figure 3-8 | Playfield Test | 3-6 |
| Figure 3-9 | Motion Object Test | 3-6 |
| Figure 3-10 | Alpha Test..... | 3-7 |
| Figure 3-11 | Color Test..... | 3-7 |
| Figure 3-12 | Color Purity Test..... | 3-7 |
| Figure 3-13 | Convergence Test | 3-8 |
| Figure 3-14 | Sound Test..... | 3-8 |
| Figure 4-1 | Control Panel Removal | 4-3 |
| Figure 4-2 | Joystick Lubrication | 4-4 |
| Figure 4-3 | Pushbutton Leaf Switch Removal | 4-5 |
| Figure 4-4 | Game PCB Removal..... | 4-6 |
| Figure 4-5 | Video Display and Speaker Removal..... | 4-7 |
| Figure 5-1 | Cabinet Mounted Assemblies | 5-2 |
| Figure 5-2 | Control Panel Assembly..... | 5-6 |
| Figure 5-3 | Joystick Assembly | 5-8 |
| Figure 5-4 | Switching/Linear (SL) Power Supply Assembly | 5-10 |
| Figure 5-5 | Linear Power Supply Assembly..... | 5-12 |
| Figure 5-6 | Coin Controls, Inc. Coin Door Assembly | 5-14 |
| Figure 5-7 | Coin Acceptors, Inc. Coin Door Assembly..... | 5-17 |
| Figure 5-8 | Gauntlet Game PCB Assembly..... | 5-20 |
| Figure 5-9 | Audio PCB Assembly | 5-30 |
| Figure 5-10 | Regulator/Audio III PCB Assembly..... | 5-32 |

List of Tables

| | | |
|-----------|--|-----|
| Table 1-1 | Game Specifications | 1-5 |
| Table 3-1 | Faulty RAM Locations | 3-2 |
| Table 3-2 | Faulty Upper or Lower Main ROM Locations | 3-3 |
| Table 3-3 | Player Control Switch Test | 3-3 |
| Table 3-4 | Game Option Settings..... | 3-4 |
| Table 3-5 | Motion Object Test Description..... | 3-6 |
| Table 3-6 | Faulty Sound RAM and ROM Locations | 3-8 |
| Table 4-1 | Recommended Preventive Maintenance Intervals | 4-2 |

First Fold



No postage necessary if mailed in the United States

BUSINESS REPLY MAIL

FIRST CLASS PERMIT NO. 173 MILPITAS, CA

POSTAGE WILL BE PAID BY ADDRESSEE

Atari Games Corporation
Attn: Customer Service
737 Sycamore Drive
P.O. Box 906
Milpitas, California 95035

Second Fold

From: _____

Regulator/Audio III Printed-Circuit Board Assembly Parts List, continued

Set-Up

| Designator | Description | Part No. |
|----------------------|--|------------|
| R19 | 5.6 k Ω , \pm 5%, 1/4 W Resistor | 110000-562 |
| R20 | 2.7 Ω , \pm 5%, 1 W Resistor | 110009-027 |
| R21 | 27 Ω , \pm 5%, 1/4 W Resistor | 110000-270 |
| R22 | 100 Ω , \pm 5%, 1/4 W Resistor | 110000-101 |
| R23 | 0.1 Ω , \pm 5%, 5 W Resistor | 116007-001 |
| R24 | 5.6 k Ω , \pm 5%, 1/4 W Resistor | 110000-562 |
| R25-R27 | 0.1 Ω , \pm 5%, 5 W Resistor | 116007-001 |
| R28 | 2.7 Ω , \pm 5%, 1/4 W Resistor | 110000-027 |
| R29 | 7.5 k Ω , \pm 5%, 1/4 W Resistor | 110000-752 |
| R31 | 3.9 k Ω , \pm 5%, 1/4 W Resistor | 110000-392 |
| R32 | 2.7 Ω , \pm 5%, 1/4 W Resistor | 110000-027 |
| R33, R34 | 22 k Ω , \pm 5%, 1/4 W Resistor | 110000-223 |
| Transistors | | |
| Q6 | TIP-32 Transistor | 33-TIP32 |
| Q7, Q8 | Type-2N3055 Transistor | 34-2N3055 |
| Miscellaneous | | |
| Q1, Q2 | Type-TDA-2030 Amplifier | 137301-001 |
| Q3 | Type-7815, + 15 V Regulator | 37-7815 |
| Q4 | Type-7915, - 15 V Regulator | 37-7915 |
| Q5 | Type-LM305 Regulator | 37-LM305 |
| R30 | 1k Horizontal Potentiometer | 119002-102 |
| (Q4, Q6) | Thermal Insulator | 78-16014 |
| (Q7, Q8) | Thermally Conductive Insulator | 78-16008 |
| | RTV Silicon Rubber Sealing Compound | 78-13003 |
| | Heat Sink | 034531-01 |
| | Test Point (Acceptable substitute is part no. 020670-01) | 179051-002 |



How to Use This Manual

This manual includes information for setting up, playing, and maintaining your Gauntlet™ game.

This manual is divided into the following chapters:

- Chapter 1 contains set-up information.
- Chapter 2 contains game play information.
- Chapter 3 contains self-test procedures.
- Chapter 4 contains preventive and corrective maintenance procedures.
- Chapter 5 contains illustrated parts lists.

Schematic diagrams for the Gauntlet game circuitry are in the SP-284 Schematic Package Supplement included with this manual.

This chapter includes information for inspecting the game, installing the control panel, and setting up the game for operation. Read the information in this chapter carefully before applying power to the game.

⚠ WARNING ⚠

To avoid electrical shock, do not plug in the game until it has been properly inspected and set up for the line voltage in your area.

This game should only be connected to a grounded three-wire outlet. If you only have a two-wire outlet, we recommend you hire a licensed electrician to install a grounded outlet. Players may receive an electrical shock if the game is not properly grounded.

Do not touch internal parts of the display with your hands or with metal objects.

Chapter 1

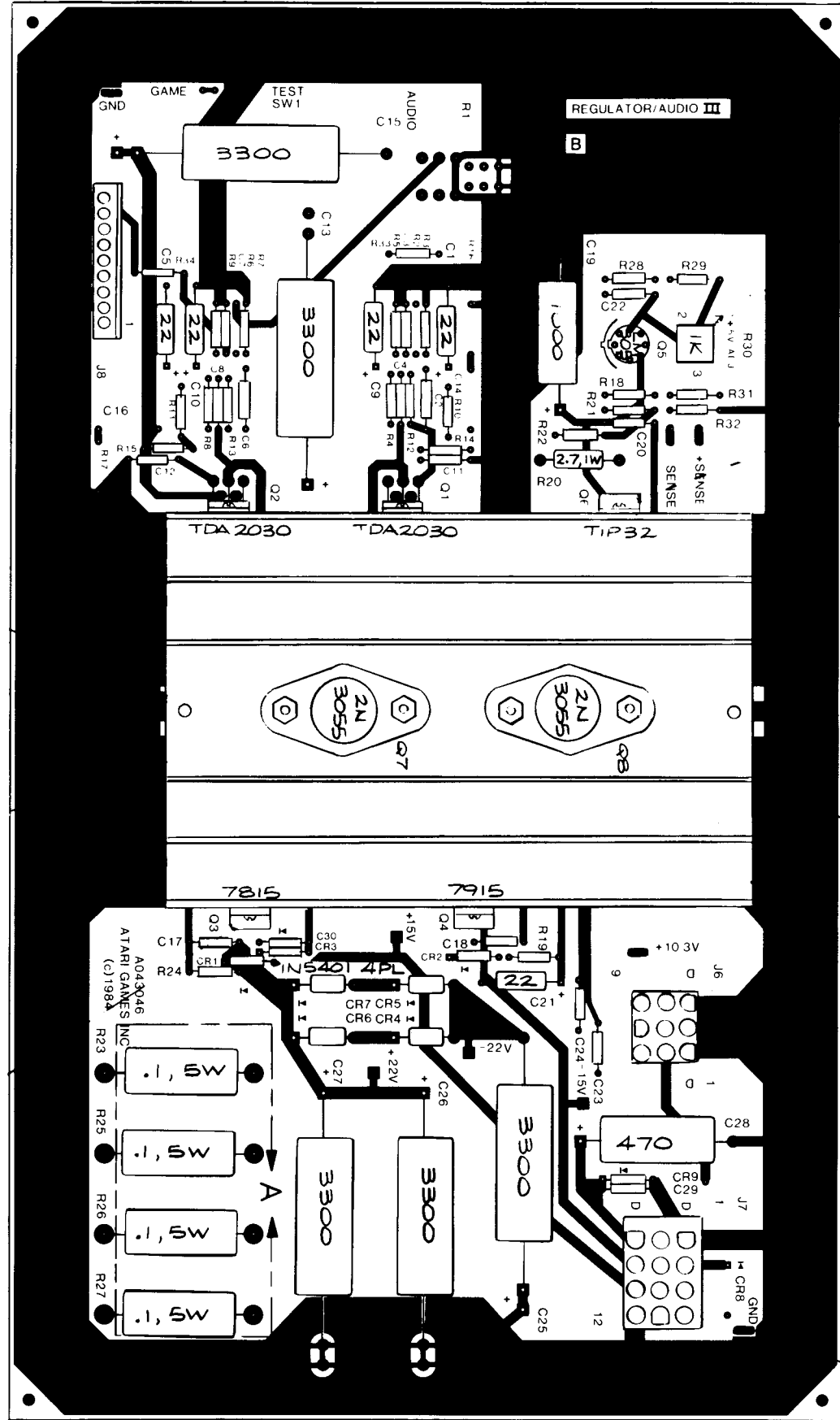

CONFIDENTIAL. Reproduction forbidden without the specific written permission of Atari Games Corporation, Sunnyvale, CA. This drawing is only conditionally issued, and neither receipt nor possession thereof confers or transfers any right in, or license to use, the subject matter of the drawing or any design or technical information shown therein, nor any right to reproduce this drawing or any part thereof. Except for manufacture by vendors of Atari Games Corporation, and for manufacture under the corporation's written license, no right is granted to reproduce this drawing or the subject matter thereof, unless by written agreement with or written permission from the corporation.

Figure 5-10 Regulator/Audio III Printed-Circuit Board Assembly
A043046-01 C

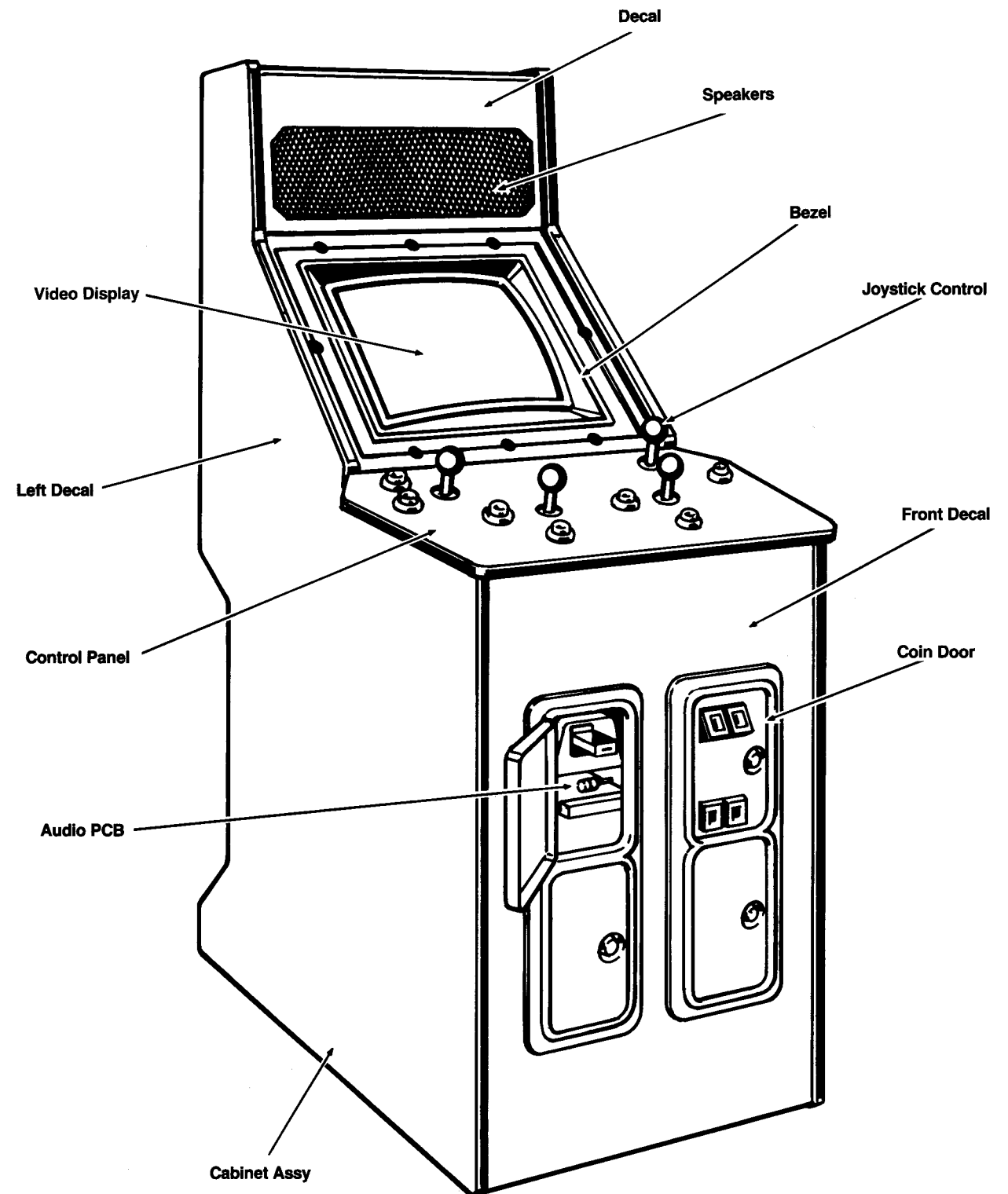
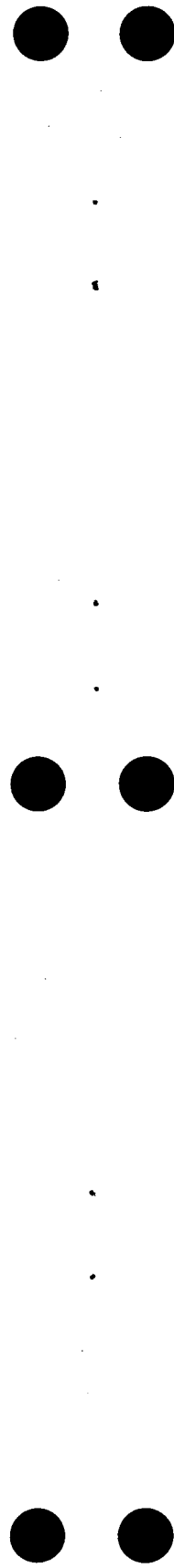

NOT SHOWN:
Regulator/Audio III PCB Assy. (Ireland only)
Utility Panel (Ireland only)

Figure 1-1 Game Overview

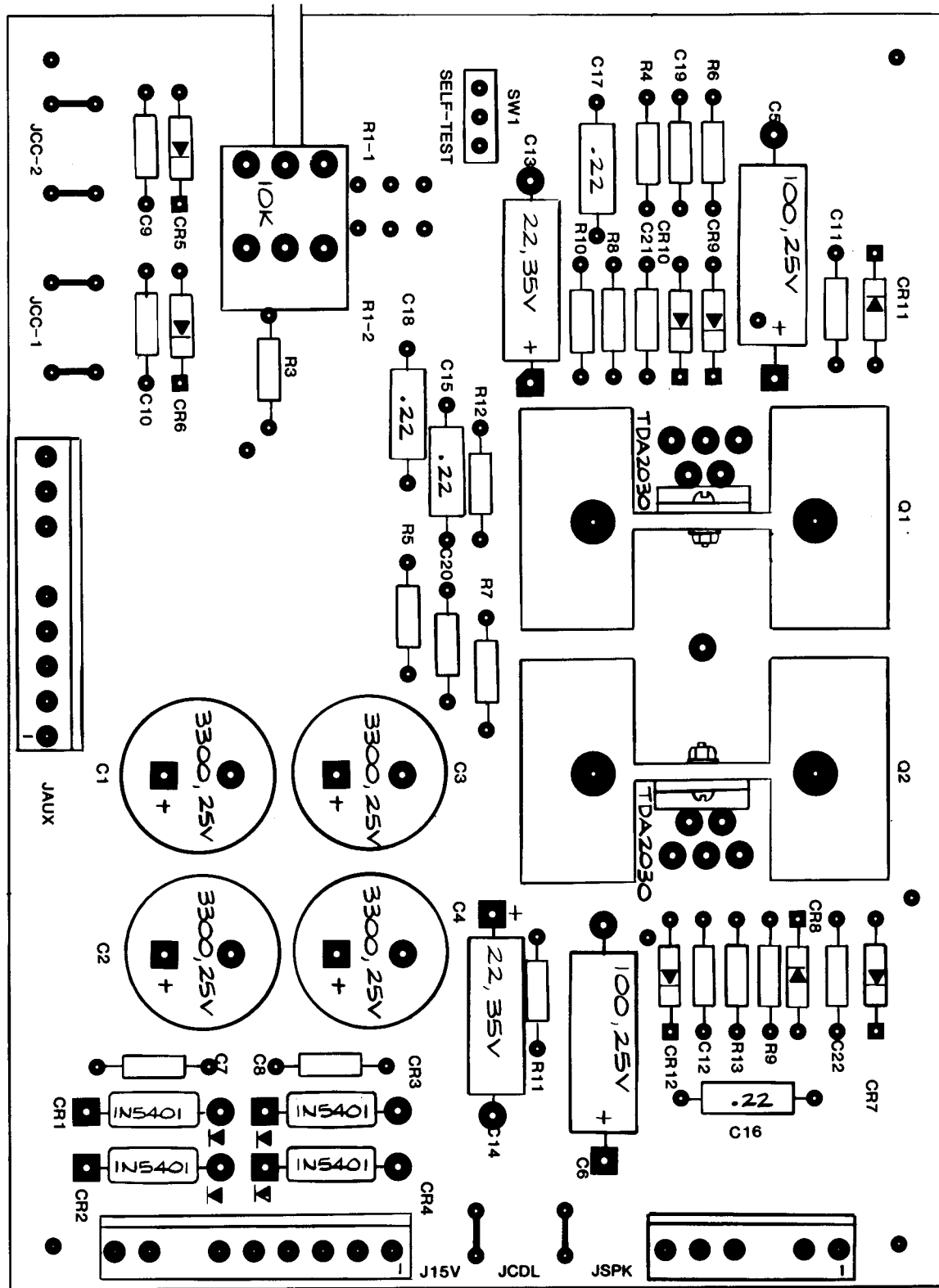

Figure 5-9 Audio PCB Assembly
A043354-01 B

CONFIDENTIAL: Reproduction forbidden without the specific written permission of Atari Games Corporation, Sunnyvale, CA. This drawing is only conditionally issued under license to the possessor thereof and is not to be used, copied, or otherwise reproduced in any form without the prior written permission of Atari Games Corporation. The subject matter of this drawing is the property of Atari Games Corporation and is not to be used, copied, or otherwise reproduced in any form without the prior written permission of Atari Games Corporation.

Table 1-1 Game Specifications

| Characteristic | Specification |
|-------------------|---|
| Power Consumption | 175 V-A, 125 W RMS maximum |
| Temperature | + 5° to + 38° C (+ 37° to + 100° F) |
| Humidity | Not to exceed 95% relative |
| Line Voltage | 110 to 132 VAC (U.S. games) 200 to 264 VAC (Irish games) |
| Width | 29 1/8 in. (74 cm) |
| Depth | 39 in. (99 cm) |
| Height | 66 in. (168 cm) |
| Weight | 293 lbs. (133 kg) |

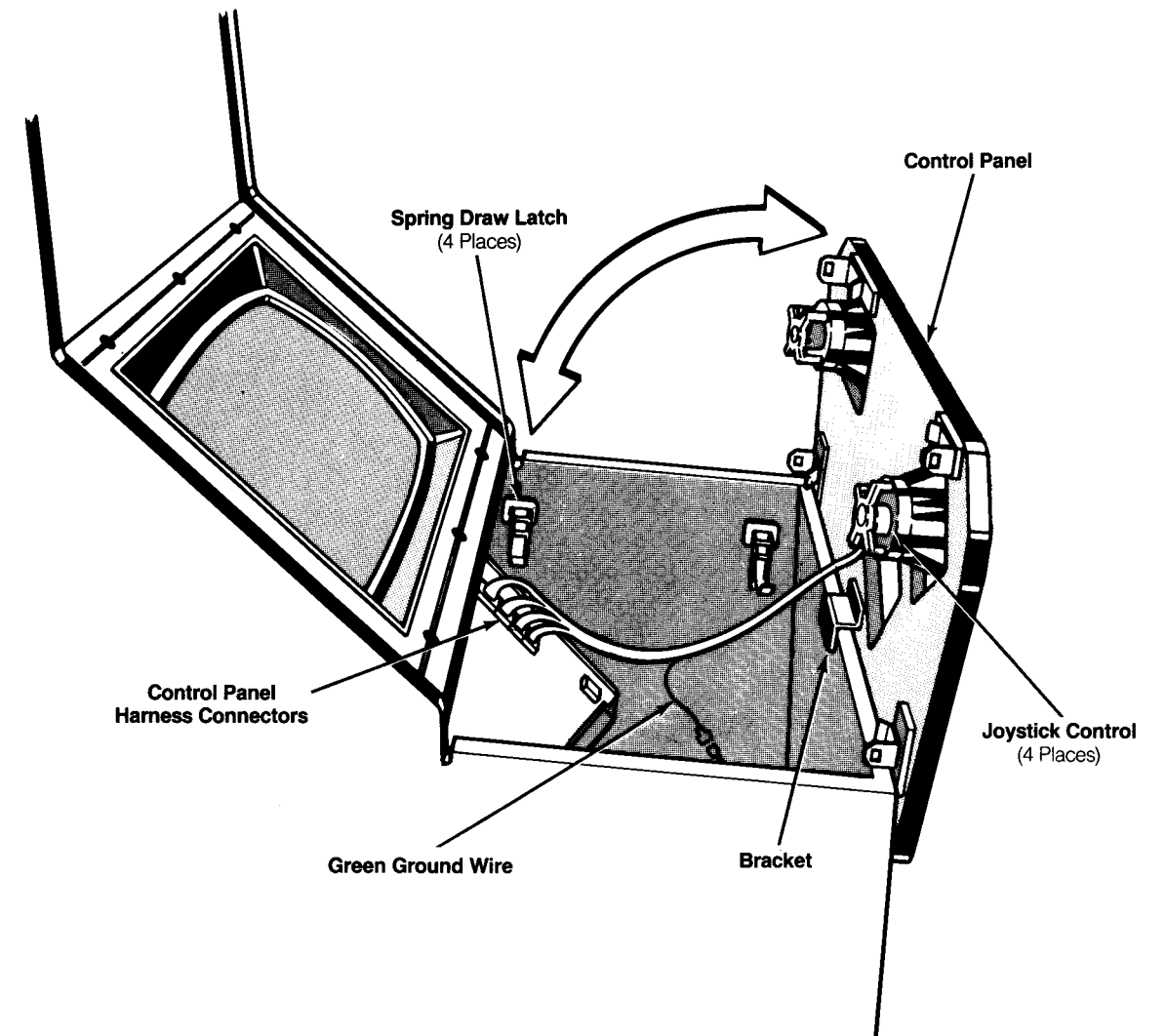

Figure 1-2 Control Panel Installation

Gauntlet Game PCB Assembly Parts List, Continued

| Designator | Description | Part No. |
|------------|--------------------------------|------------|
| R65 | Resistor, ¼ W, 8.2 kΩ, ± 5% | 110000-822 |
| R66 | Resistor, ¼ W, 3.9 kΩ, ± 5% | 110000-392 |
| R67 | Resistor, ¼ W, 10 kΩ, ± 5% | 110000-103 |
| R68 | Resistor, ¼ W, 1.8 kΩ, ± 5% | 110000-182 |
| R69, R70 | Resistor, ¼ W, 2 kΩ, ± 5% | 110000-202 |
| R71 | Resistor, ¼ W, 5.6 kΩ, ± 5% | 110000-562 |
| R72 | Resistor, ¼ W, 1.2 kΩ, ± 5% | 110000-122 |
| R73 | Resistor, ¼ W, 470 Ω, ± 5% | 110000-471 |
| R74 | Resistor, ¼ W, 75 kΩ, ± 5% | 110000-753 |
| R75 | Resistor, ¼ W, 150 kΩ, ± 5% | 110000-154 |
| R76 | Resistor, ¼ W, 300 kΩ, ± 5% | 110000-304 |
| R78 | Resistor, ¼ W, 75 kΩ, ± 5% | 110000-753 |
| R79 | Resistor, ¼ W, 150 kΩ, ± 5% | 110000-154 |
| R80 | Resistor, ¼ W, 47 kΩ, ± 5% | 110000-473 |
| R81 | Resistor, ¼ W, 30 kΩ, ± 5% | 110000-303 |
| R82 | Resistor, ¼ W, 7.5 kΩ, ± 5% | 110000-752 |
| R83, R84 | Resistor, ¼ W, 15 kΩ, ± 5% | 110000-153 |
| R85 | Resistor, ¼ W, 7.5 kΩ, ± 5% | 110000-752 |
| R86 | Resistor, ¼ W, 30 kΩ, ± 5% | 110000-303 |
| R87-94 | Resistor, ¼ W, 12 kΩ, ± 5% | 110000-123 |
| R95 | Resistor, ¼ W, 560 Ω, ± 5% | 110000-561 |
| R96-103 | Resistor, ¼ W, 1 kΩ, ± 5% | 110000-102 |
| R104 | Resistor, ¼ W, 220 Ω, ± 5% | 110000-221 |
| R105-112 | Resistor, ¼ W, 1 kΩ, ± 5% | 110000-102 |
| R113 | Resistor, ¼ W, 220 Ω, ± 5% | 110000-221 |
| R114-121 | Resistor, ¼ W, 1 kΩ, ± 5% | 110000-102 |
| R122, R123 | Resistor, ¼ W, 220 Ω, ± 5% | 110000-221 |
| R124-131 | Resistor, ¼ W, 1 kΩ, ± 5% | 110000-102 |
| R132, R133 | Resistor, ¼ W, 10 kΩ, ± 5% | 110000-103 |
| R134, R135 | Resistor, ¼ W, 1 kΩ, ± 5% | 110000-102 |
| R136 | Resistor, ¼ W, 220 Ω, ± 5% | 110000-221 |
| R137 | Resistor, ¼ W, 12 kΩ, ± 5% | 110000-123 |
| R138, R139 | Resistor, ¼ W, 1 kΩ, ± 5% | 110000-102 |
| R150-155 | Resistor, ¼ W, 1 kΩ, ± 5% | 110000-102 |
| R228 | Resistor, ¼ W, 390 Ω, ± 5% | 110000-391 |
| R229-231 | Resistor, ¼ W, 3.9 kΩ, ± 5% | 110000-392 |
| RN1, RN2 | Resistor, SIP, 470 Ω (10-Pin) | 118010-471 |
| RN3-6 | Resistor, SIP, 4.7 kΩ (10-Pin) | 118010-472 |
| RN7 | Resistor, SIP, 470 Ω (8-Pin) | 118007-471 |
| RN8 | Resistor, SIP, 1 kΩ (6-Pin) | 118009-102 |
| RN9 | Resistor, SIP, 1 kΩ (6-Pin) | 118009-102 |
| RN10-13 | Resistor, SIP, 470 Ω (10-Pin) | 118010-471 |

Game Play

Gauntlet™ is a one-, two-, three- or four-player game where the players cooperatively explore a multitude of mazes. As players cooperate to fight off common enemies and try to find their way out of the various mazes, they must also compete with each other for food, treasure, magic potions and other helpful items.

Introduction

The player controls consist of an eight-position joystick that moves the player's character and directs fire. While the Fire button is pressed, the player's character stops; the player then selects the direction of fire with the joystick. Each player is allowed one shot at a time. If the Fire button is held down, it will repeat fire as fast as possible.

The player can collect and save magic potions for later use by touching them with his character. The player can press the Magic button when he wants to use the potions he has collected.

Up to four players can play at once. Each new player can enter a game at any time. Each player chooses one of four available characters: Thor the Warrior, Thyra the Valkyrie, Merlin the Wizard, or Questor the Elf. Each of these characters has unique capabilities. For instance, Thyra has great armor, Thor is best at hand-to-hand combat, while Questor has the fastest speed, and Merlin has the best ability to use magic. Complete character descriptions are included on the Gauntlet control panel.

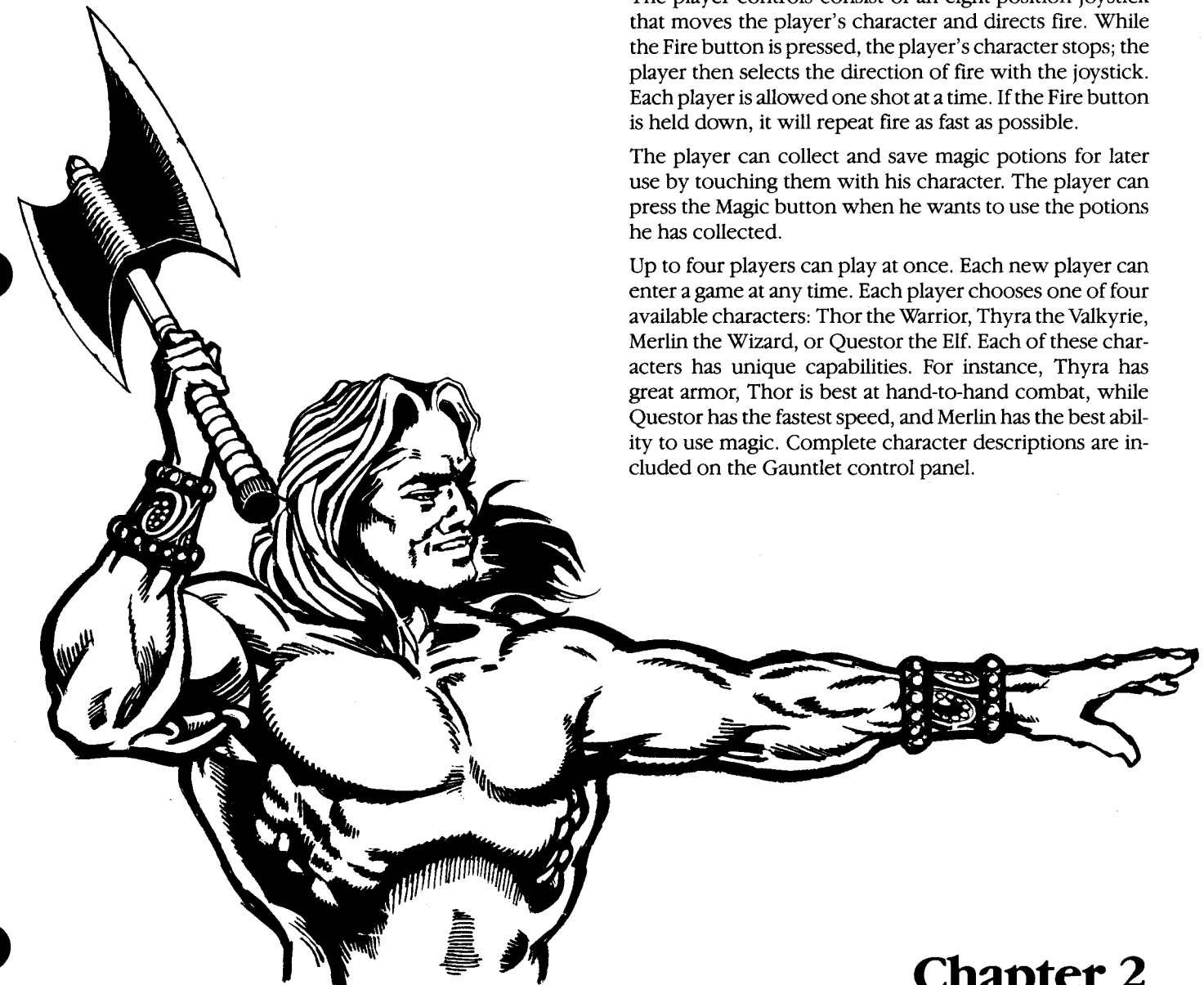

Chapter 2

Gauntlet Game PCB Assembly Parts List, Continued

| Designator | Description | Part No. |
|------------------------------------|---|------------|
| C59 | Capacitor, Electrolytic, 10 μ f, 25 V | 24-250106 |
| C60, C61 | Capacitor, Ceramic, 1000 pf, 100 V | 122016-102 |
| C62-128 | Capacitor, Ceramic, .1 μ f, 50 V | 122002-104 |
| C140-192 | Capacitor, Ceramic, .1 μ f, 50 V | 122002-104 |
| C193 | Capacitor, Ceramic, .0027 μ f, 50 V | 122015-272 |
| C194 | Capacitor, Ceramic, .0012 μ f, 50 V | 122015-122 |
| C195 | Capacitor, Ceramic, .0068 μ f, 50 V | 122015-682 |
| C196-198 | Capacitor, Mica, 100 pf, 100 V | 128002-101 |
| Diodes | | |
| CR1 | Diode, Zener, 1N754A | 131002-001 |
| CR2 | Diode, Light-Emitting, MV5053 | 38-MV5053 |
| Ferrite Beads and Inductors | | |
| L1-3 | Ferrite Bead, N12N | 141003-005 |
| L4 | Inductor, 100 μ H | 41-3003 |
| Connectors | | |
| PCOIN | Connector, 6-Pin, 0.1-Inch Centers | 179118-006 |
| PPL1-PPL4 | Connector, 11-Pin, 0.1-Inch Centers | 179118-011 |
| PPWR | Connector, 12-Pin | 179069-012 |
| PST | Connector, 11-Pin, 0.1-Inch Centers | 179118-011 |
| PV1D | Connector, 11-Pin, 0.1-Inch Centers | 179118-011 |
| PWR-RES | Connector, Header, 2-Circuit | 179048-002 |
| SROM | Connector, Receptacle, 2-Circuit | 179178-002 |
| SROM | Connector, Header, 2-Circuit | 179048-002 |
| WDIS | Connector, Header, 2-Circuit | 179048-002 |
| Transistors | | |
| Q1 | Transistor, 2N3904 | 34-2N3904 |
| Q2 | Transistor, 2N3906 | 33-2N3906 |
| Q3, Q4 | Transistor, 2N3904 | 34-2N3904 |
| Q5 | Transistor, 2N3906 | 33-2N3906 |
| Q6, Q7 | Transistor, 2N3904 | 34-2N3904 |
| Q8 | Transistor, 2N3906 | 33-2N3906 |
| Q9, Q10 | Transistor, 2N3904 | 34-2N3904 |
| Q11 | Transistor, 2N3906 | 33-2N3906 |
| Q12, Q13 | Transistor, 2N3904 | 34-2N3904 |
| Q15 | Transistor, 2N3904 | 34-2N3904 |
| Q17 | Transistor, 2N6044 | 34-2N6044 |
| Q18 | Transistor, 2N6044 | 34-2N6044 |
| Resistors | | |
| R1 | Resistor, $\frac{1}{4}$ W, 470 Ω , $\pm 5\%$ | 110000-471 |
| R2 | Resistor, $\frac{1}{4}$ W, 4.7 k Ω , $\pm 5\%$ | 110000-472 |
| R3 | Resistor, $\frac{1}{4}$ W, 2.4 k Ω , $\pm 5\%$ | 110000-242 |
| R4 | Resistor, $\frac{1}{4}$ W, 1.2 k Ω , $\pm 5\%$ | 110000-122 |
| R5 | Resistor, $\frac{1}{4}$ W, 620 Ω , $\pm 5\%$ | 110000-621 |
| R6 | Resistor, $\frac{1}{4}$ W, 470 Ω , $\pm 5\%$ | 110000-471 |
| R7 | Resistor, $\frac{1}{4}$ W, 4.7 k Ω , $\pm 5\%$ | 110000-472 |
| R8 | Resistor, $\frac{1}{4}$ W, 2.4 k Ω , $\pm 5\%$ | 110000-242 |

enter his first initial and 15 seconds for each of his next two initials. Players select their initials by moving the joystick and pressing the Magic or Fire buttons when the proper initial is displayed. Players can correct their initials by selecting the arrow that points to the left and pressing the Magic or Fire buttons, then repeating the procedure for entering their correct initials.

Hints for Game Play

The following hints will help you use your health more effectively and score more points per coin:

- Play cooperatively.
- Allow the player with the best ability to use magic (usually Merlin the Wizard, unless one of the other players has acquired the magic potion for extra magic) to pick up the magic potions.
- Save keys and potions and use them conservatively.
- Pay attention to your marching order. Allow the players with the best fighting ability and armor (usually Thyra the Valkyrie and Thor the Warrior) to lead the way and fend off attacks.
- Avoid contact with the ghosts: they take away your health very quickly and you cannot fight them hand-to-hand.

Maximizing Earnings

The Gauntlet game is designed to insure maximum earnings. In addition to the multiple-player aspect of the game, messages appear on the screen that encourage players to deposit more coins. Players can continue to buy health and play for as long as they want and explore an infinite number of levels.

Operator options on this game have been kept very simple. Thoroughly read Chapter 3, Self-Test, for the Coin Options, Game Options, Histograms, and Statistics screens so that you can effectively use the options available. Use the Self-Test screens showing Statistics and His-

tograms to evaluate game data, and the Game Options screen to make adjustments.

The key to maximum earnings is striking a midpoint on game times. Game times must be short enough so that player turnover is high. Conversely, game times must be long enough to give a player a good value and insure repeat play (repeat play is crucial to longevity). Gauntlet gives the operator the flexibility to tune game difficulty and enough statistics to intelligently make adjustments.

NOTE

The following recommendations are based on 25¢ per play, U.S. currency.

If collections seem low or are dropping off, check all player controls and coin mechanisms for proper operation. If the average game time per quarter is under 90 seconds, try changing the amount of health per coin to a higher number. This change should be quite obvious to players and should encourage more game play. If game times are still too short after a few weeks on a higher health per coin setting, try changing the game difficulty to an easier setting.

If the average game time per quarter is over 180 seconds, first try changing the game difficulty to a harder setting. If after a few weeks at this harder setting the average game time per quarter is still over 180 seconds, try an even harder setting. The amount of health per coin can also be reduced; however, this change will be more obvious to players and is likely to discourage them.

After changing the game difficulty settings, always clear or reset the Statistics by pressing the Warrior Magic button in the last Statistics screen.

Self-Test Mode

You can set the Gauntlet game to the Self-Test Mode by switching on the Self-Test switch behind the upper right coin door. Refer to Chapter 3 of this manual for detailed self-test information.

**Gauntlet Game PCB Assembly
Parts List, Continued**

| Designator | Description | Part No. |
|------------|--|-------------|
| 11C | Integrated Circuit, 74LS244 | 37-74LS244 |
| 11D | Integrated Circuit, 74LS244 | 37-74LS244 |
| 11J | Integrated Circuit, 74LS20 | 37-74LS20 |
| 11N | Integrated Circuit, 74LS163A | 37-74LS163A |
| 11P | Integrated Circuit, 74LS08 | 37-74LS08 |
| 11R | Integrated Circuit, 74LS197 | 137240-001 |
| 11S | Integrated Circuit, 74LS02 | 37-74LS02 |
| 11T | Integrated Circuit, 7406 | 37-7406 |
| 12C | Integrated Circuit, 74LS245 | 37-74LS245 |
| 12D | Integrated Circuit, 74LS245 | 37-74LS245 |
| 12E | Integrated Circuit, Microprocessor, MC68010-L8 | 137414-001 |
| 12J | Integrated Circuit, 74LS74 | 37-74LS74 |
| 12K | Integrated Circuit, Custom, PFHS | 137419-104 |
| 12M | Integrated Circuit, Custom, GPC | 137419-101 |
| 12N | Integrated Circuit, 74LS32 | 37-74LS32 |
| 12P | Integrated Circuit, 74LS244 | 37-74LS244 |
| 12R | Integrated Circuit, 74LS138 | 137177-001 |
| 12S | Integrated Circuit, 74LS00 | 37-74LS00 |
| 13C | Integrated Circuit, 74LS244 | 37-74LS244 |
| 13D | Integrated Circuit, 74LS244 | 37-74LS244 |
| 13J | Integrated Circuit, 74LS374 | 37-74LS374 |
| 13K | Integrated Circuit, 7407 | 37-7407 |
| 13L | Integrated Circuit, 74LS139 | 37-74LS139 |
| 13M | Integrated Circuit, 74LS139 | 37-74LS139 |
| 13N | Integrated Circuit, 74LS74 | 37-74LS74 |
| 13P | Integrated Circuit, 74LS273 | 37-74LS273 |
| 13R | Integrated Circuit, TMS5220C | 137308-002 |
| 13/14A | Integrated Circuit, EPROM, 2804A | 137329-450 |
| 13/14U | Integrated Circuit, LM324 | 37-LM324 |
| 14A | Integrated Circuit, 74LS259 | 37-74LS259 |
| 14A/B | Integrated Circuit, 74LS244 | 37-74LS244 |
| 14B | Integrated Circuit, 74LS244 | 37-74LS244 |
| 14C | Integrated Circuit, 74LS244 | 37-74LS244 |
| 14D | Integrated Circuit, 74LS138 | 137177-001 |
| 14E | Integrated Circuit, 74LS244 | 37-74LS244 |
| 14F | Integrated Circuit, 74LS244 | 37-74LS244 |
| 14J | Integrated Circuit, 74LS374 | 37-74LS374 |
| 14K | Integrated Circuit, 74LS138 | 137177-001 |
| 14L | Integrated Circuit, 74LS04 | 37-74LS04 |
| 14M | Integrated Circuit, 74LS74 | 37-74LS74 |
| 14N | Integrated Circuit, 74LS08 | 37-74LS08 |
| 14P | Integrated Circuit, 74LS139 | 37-74LS139 |
| 14S | Integrated Circuit, 74LS169 | 137109-001 |
| 14T | Integrated Circuit, LM324 | 37-LM324 |

Self-Test

This game will test itself and provide visual and audible indications of the condition of the game circuitry and controls. Self-test information is visually displayed on the screen and audibly presented through the sound system. No additional equipment is required.

We suggest that you perform a self-test when you first set up the game, each time you collect the money, or when you suspect game failure. Coin and game options are selected in the Self-Test Mode.

Thirteen self-test screens provide a visual and audible check of the Gauntlet game circuits. Refer to Chapter 1 for the self-test switch location.

When the self-test switch is turned on, the game enters the Self-Test Mode. The following self-test screens are arranged in the sequence in which they occur when the self-test switch is turned on. After the Sound Test, the sequence starts over with the Switch Test. Turning the self-test switch off at any time during the Self-Test Mode causes the game to return to the Attract Mode.



Chapter 3

Gauntlet Game PCB Assembly Parts List, Continued

| Designator | Description | Part No. |
|------------|-----------------------------------|-------------|
| 4U | Integrated Circuit, 74S08 | 37-74S08 |
| 4W | Integrated Circuit, 74S374 | 137206-001 |
| 4X | Integrated Circuit, 74LS244 | 37-74LS244 |
| 5C | Integrated Circuit, 74LS273 | 37-74LS273 |
| 5D | Integrated Circuit, 74LS283 | 137204-001 |
| 5E | Integrated Circuit, 74LS283 | 137204-001 |
| 5F | Integrated Circuit, 74LS163A | 37-74LS163A |
| 5J | Integrated Circuit, 74LS163A | 37-74LS163A |
| 5K | Integrated Circuit, 74LS273 | 37-74LS273 |
| 5L | Integrated Circuit, PROM, 82S147 | 136037-102 |
| 5N | Integrated Circuit, 74LS283 | 137204-001 |
| 5P | Integrated Circuit, 74LS283 | 137204-001 |
| 5R | Integrated Circuit, 74LS169 | 137109-001 |
| 5S | Integrated Circuit, 74LS175 | 37-74LS175 |
| 5T | Integrated Circuit, 74LS175 | 37-74LS175 |
| 5W | Integrated Circuit, 74S374 | 137206-001 |
| 5X | Integrated Circuit, 74LS244 | 37-74LS244 |
| 6C | Integrated Circuit, RAM, 1MS1420L | 137360-001 |
| 6D | Integrated Circuit, RAM, 1MS1420L | 137360-001 |
| 6E | Integrated Circuit, RAM, 1MS1420L | 137360-001 |
| 6F | Integrated Circuit, RAM, 1MS1420L | 137360-001 |
| 6J | Integrated Circuit, RAM, 1MS1420L | 137360-001 |
| 6K | Integrated Circuit, RAM, 1MS1420L | 137360-001 |
| 6L | Integrated Circuit, 74LS283 | 137204-001 |
| 6M | Integrated Circuit, 74LS175 | 37-74LS175 |
| 6P | Integrated Circuit, EPROM, 300ns | 136037-104 |
| 6S | Integrated Circuit, 74LS74 | 37-74LS74 |
| 6T | Integrated Circuit, 74LS20 | 37-74LS20 |
| 6U | Integrated Circuit, 74LS174 | 37-74LS174 |
| 6W | Integrated Circuit, 74LS74 | 37-74LS74 |
| 6X | Integrated Circuit, 74LS74 | 37-74LS74 |
| 7A | Integrated Circuit, EPROM, 200ns | 136037-109 |
| 7B | Integrated Circuit, EPROM, 200ns | 136037-110 |
| 7C | Integrated Circuit, RAM, 1MS1420L | 137360-001 |
| 7D | Integrated Circuit, RAM, 1MS1420L | 137360-001 |
| 7E | Integrated Circuit, RAM, 1MS1420L | 137360-001 |
| 7F | Integrated Circuit, RAM, 1MS1420L | 137360-001 |
| 7J | Integrated Circuit, RAM, 1MS1420L | 137360-001 |
| 7K | Integrated Circuit, RAM, 1MS1420L | 137360-001 |
| 7L | Integrated Circuit, 74LS153 | 37-74LS153 |
| 7M | Integrated Circuit, 74LS175 | 37-74LS175 |
| 7N | Integrated Circuit, 74LS194A | 37-74LS194 |
| 7P | Integrated Circuit, 74LS194A | 37-74LS194 |
| 7R | Integrated Circuit, 74LS273 | 37-74LS273 |

**Table 3-2 Faulty Upper or Lower
Main ROM Locations**

| Error Address | Location | |
|---------------|----------|---------|
| Main ROM | U = 9A | L = 9B |
| 38000 | U = 10A | L = 10B |
| 40000 | U = 7A | L = 7B |

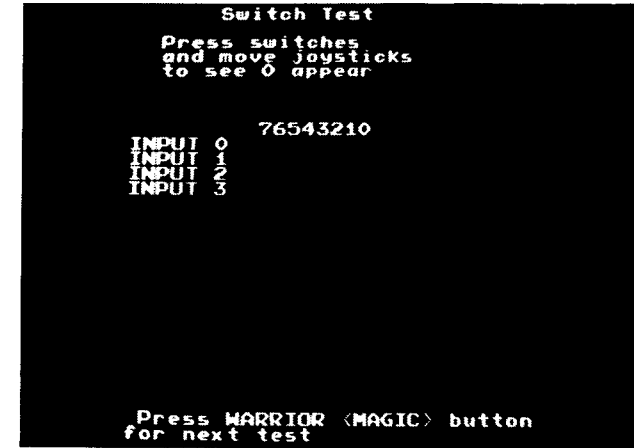

Figure 3-3 Switch Test

Table 3-3 Player Control Switch Test

| Procedure | Test Indication | | | | | | | |
|----------------|-----------------|---|---|---|---|---|---|---|
| | 7 | 6 | 5 | 4 | 3 | 2 | 1 | 0 |
| Joystick up | 0 | | | | | | | |
| Joystick down | | 0 | | | | | | |
| Joystick left | | | 0 | | | | | |
| Joystick right | | | | 0 | | | | |
| Press Fire | | | | | | 0 | | |
| Press Magic | | | | | | | | 0 |

Switch Test

The Switch Test is shown in Figure 3-3. This test checks the condition of the player controls. *INPUT 0* through *3* in the display corresponds to the player controls as follows:

- INPUT 0 = Warrior (Thor)
- INPUT 1 = Valkyrie (Thyra)
- INPUT 2 = Wizard (Merlin)
- INPUT 3 = Elf (Questor)

Operate the joysticks and pushbuttons for each player and check that the screen displays a 0 (zero) under the appropriate row of numbers as shown in Table 3-3.

If the joysticks are not placed exactly in one of the four quadrant positions, two zeros may appear in the display. However, if two zeros appear in all joystick positions or when any of the buttons are pressed, there may be a short between the joystick or pushbutton switches. This is indicated by the locations of the zeros. For example, when the joystick is moved to the right or left, zeros under the numbers 4 and 5 indicate a possible short between the right and left joystick leaf switches. No zeros when a control is operated indicates a possible open leaf switch contact.

Press the Warrior Magic button to obtain the next screen.

Coin Options

The Coin Options screen is shown in Figure 3-4. The Coin Options screen indicates the current coin option settings and is used to change those settings.

MULTIPLIER should have a red box around it. Move the Warrior joystick right or left to cycle through eight multiplier selections as follows:

- 1 Coin Counts as 1 Coin (Default)
- 1 Coin Counts as 2 Coins
- 1 Coin Counts as 3 Coins
- 1 Coin Counts as 4 Coins
- 1 Coin Counts as 5 Coin
- 1 Coin Counts as 6 Coins
- 1 Coin Counts as 7 Coins
- 1 Coin Counts as 8 Coins

Select the desired value. Note that the default (recommended) setting of *1 Coin Counts as 1 Coin* is highlighted in green.

Move the Warrior joystick down to move the red box to *BONUS ADDER*. Move the Warrior joystick right or left to cycle through seven bonus adder selections as follows:

- None (Default)
- 2 Coins Give 1 Extra Coin

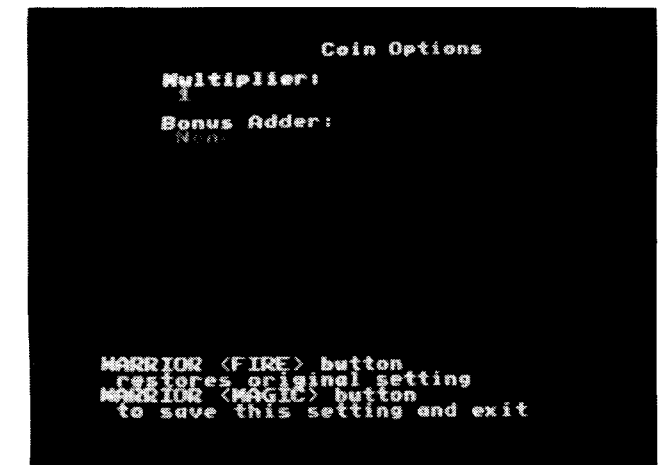

Figure 3-4 Coin Options

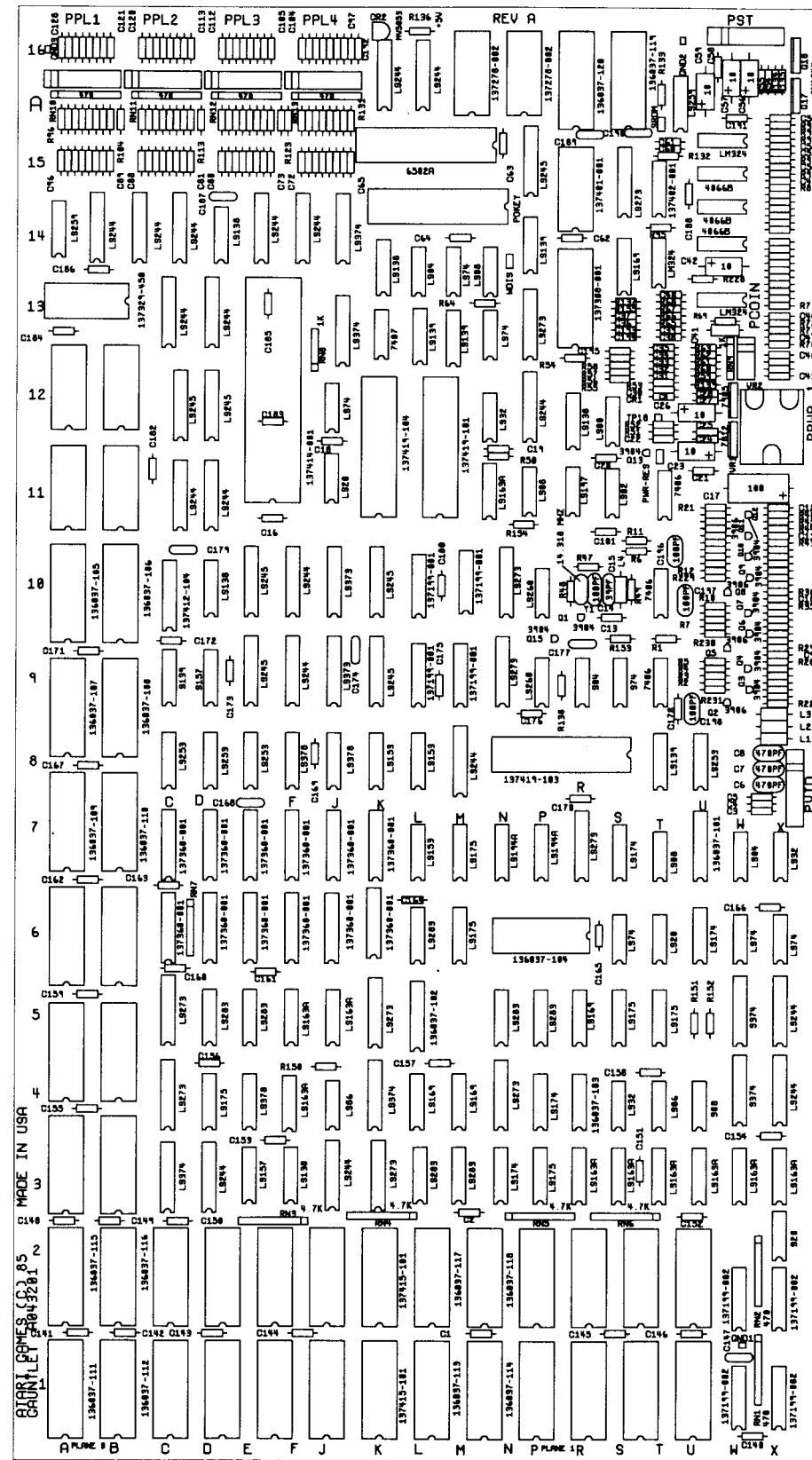

Figure 5-8 Gauntlet Game PCB Assembly A043201-21 B

NOTICE TO ALL PERSONS RECEIVING THIS DRAWING: CONFIDENTIAL. Reproduction forbidden without the specific written permission of Atari Games Corporation, Sunnyvale, CA. This drawing is only conditionally issued, and neither receipt nor possession thereof confers any right in, or license to use, the subject matter of the drawing or any design or technical information shown thereon, nor any right to reproduce this drawing or any part thereof. Except for manufacture by vendors of Atari Games Corporation, and for manufacture under the corporation's written license, no right is granted to reproduce this drawing or the subject matter thereof, unless by written agreement with or written permission from the corporation.

Magic button, the High Score Table will automatically be reset to the factory scores and initials after every 2,000 games, but no less than 200 games since the last player entered initials.

Disable Speech—If you select *Yes* and exit the Game Options screen by pressing the Warrior Magic button, the speech portion of the game sounds will be disabled.

Press the Warrior Magic button to obtain the next screen.

Statistics

The Statistics screen appears as shown in Figure 3-6. This screen provides a visual check of the current game statistics. The statistics information is accumulated either from the first time the game was turned on or from the last time the statistics were reset. To reset the statistics information, press the Warrior Fire button.

The following information appears on the Statistics screen:

- The *Plyr 0-3 Coin* messages show the number of coins deposited in each of the four coin mechanisms.
- The *0-4 Plyr Mins* messages show the total time, in minutes, of all the 0-, 1-, 2-, 3-, and 4-player games that were played. (A “zero-player” game is the time that the game was turned on but not being played.)
- *Total Games* shows the total number of games played. One “game” is the time between leaving the Attract Mode and returning to it, regardless of time, number of coins inserted, or how many have played Gauntlet. The games are measured since the last time the statistics were cleared.
- *Error Count* shows the number of EEPROM errors that were detected. Replace the EEPROM at location 13A on the Game PCB if the errors detected exceed approximately 75 per week.
- *Total Coins* shows the total number of coins deposited in all the coin mechanisms.

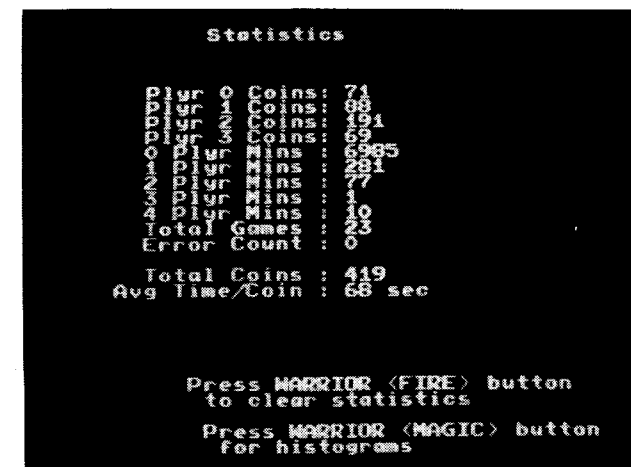

Figure 3-6 Statistics

- *Avg Time/Coin* shows the average game time per coin, in seconds, for all players.

Press the Warrior Magic button to obtain the next screen.

Histograms

One Histogram screen is shown in Figure 3-7. The Histograms for Players 0 through 3 (0 = Warrior, 1 = Valkyrie, 2 = Wizard, 3 = Elf) are selected by pressing the Warrior Magic button. For each of four players, these screens show the lengths of the games from 0 to 300 or more seconds. The Histograms also provide corresponding bar graphs.

The game times information is accumulated either from the first time the game was turned on or from the last time the game times were reset. To reset the Histograms, press the Warrior Fire button while displaying the Histogram for Player 3.

Press the Warrior Magic button to obtain the next screen.

Playfield Test

The Playfield Test appears as shown in Figure 3-8. The playfield that is displayed (Bank = 0 only, Banks 1 through 3 are not used) should not show any abnormalities. The right-hand edge of the screen should have 16 uniquely colored blocks (including two black blocks). These are the colors used in the playfield displayed on the screen. The Playfield Test indicates the condition of some of the graphics ROM, the vertical and horizontal scroll registers, and the joystick control.

Move the Warrior joystick to the left, and the playfield should slowly move to the left. Move the joystick up, and the playfield will move up—likewise for right and down. Press the Warrior Magic button to obtain the next screen.

Motion Object Test

The Motion Object Test appears as shown in Figure 3-9. The seven groups of motion objects should be (from left



Figure 3-7 Histograms

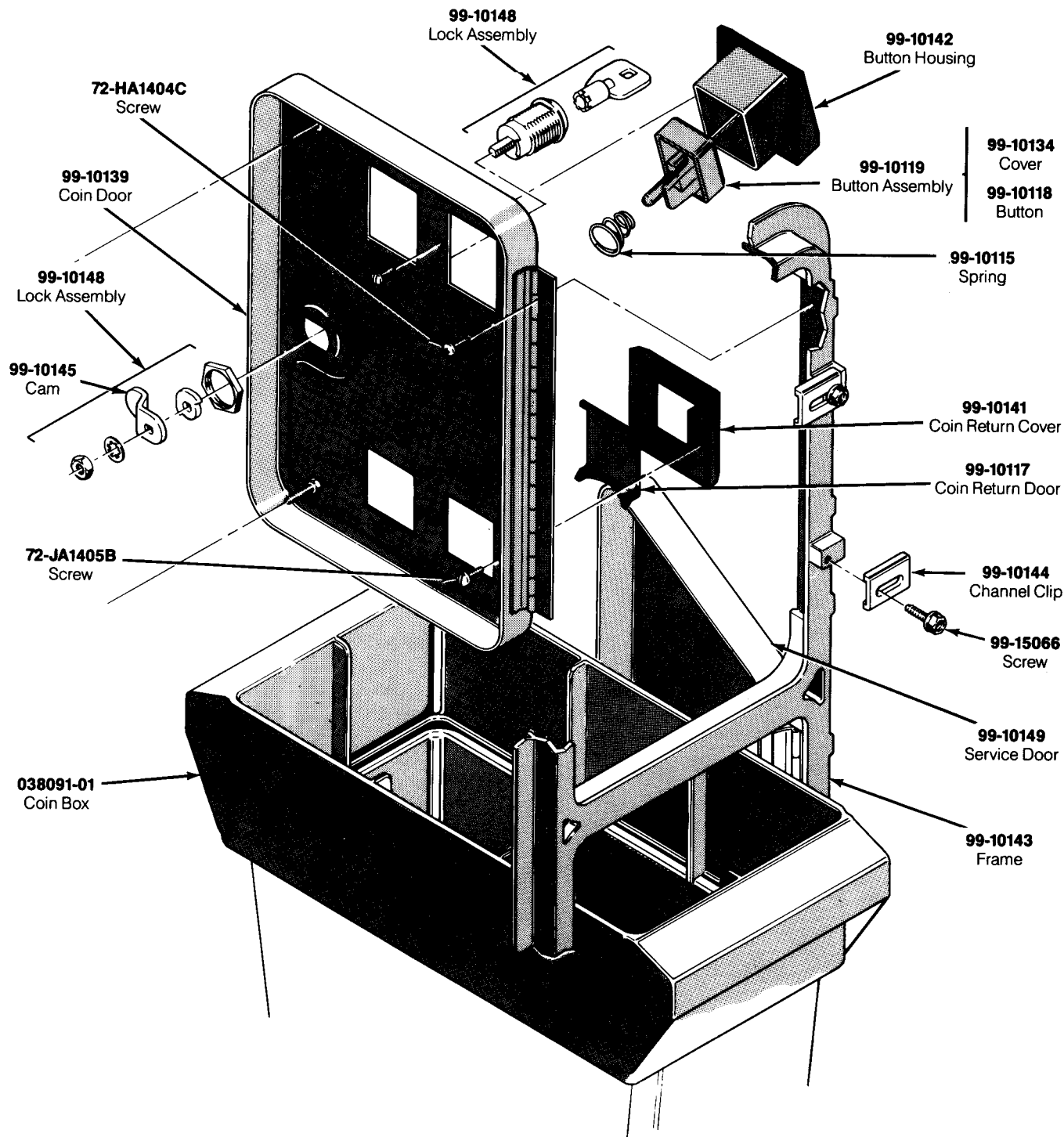

Figure 5-7 Coin Acceptors, Inc. Coin Door Assembly, continued
171027-001 A



Figure 3-10 Alpha Test

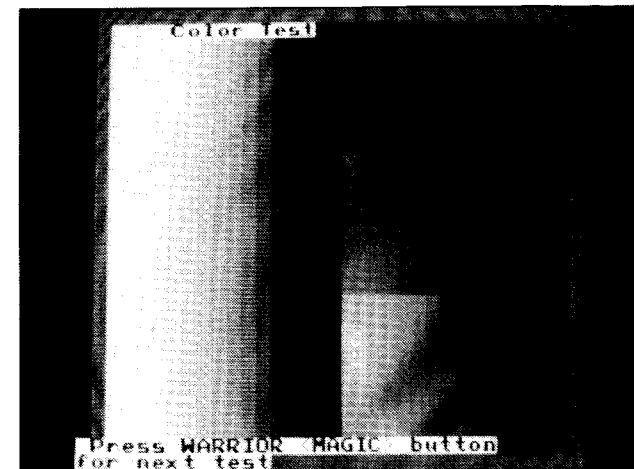

Figure 3-11 Color Test

The screen should show 16 vertical grey-scale bars and three blocks of red, green, and blue, each containing 16 vertical bars. The brightest bars should be on the left and darkest (black) on the right with a grey frame around the screen. This frame will help to identify the darkest color band. If the display characteristics are not correct, refer to the display manual for the color-gun adjustment procedure or to determine the possible cause of failure.

Press the Warrior Magic button to obtain the next screen.

Color Purity Test

The Color Purity Test consists of five color displays that indicate the condition of the display color-purity circuits. The first display to appear should be a red screen with the word RED displayed at the bottom of the screen as shown in Figure 3-12.

Press the Warrior Fire button, and the next display to appear should be green with the word GREEN displayed at the bottom of the screen. Press the Warrior Fire button to



obtain a blue, white, and finally a grey screen. After the grey screen, the display will repeat the red, green, blue, white, and grey sequence again.

If the display characteristics are not correct, refer to the display manual for the color-purity adjustment procedure or the possible cause of failure.

Press the Warrior Magic button to obtain the next screen.

Convergence Test

The Convergence Test (as shown in Figure 3-13) should show a white grid pattern. The Convergence Test indicates the condition of the display size, centering, linearity, and convergence.

Press the Warrior Fire button; the grid pattern should turn violet. Pressing the Warrior Fire button again should cause the screen to turn green. Examine the grid pattern for the following characteristics (the violet and white patterns are used to adjust the display convergence):

- Insure that the corners of the pattern touch the corners of the CRT.
- Grid lines should show no pincushioning or barreling, and the lines should be straight within 3.0 mm.
- Violet and white pattern convergence should be within 2.0 mm.

If the display characteristics are not within these limits, refer to the display manual for the linearity and convergence adjustment procedures or to determine the possible cause of failure.

Move the Warrior joystick up and the pattern should slowly scroll up the screen. Moving the Warrior joystick to the left, right, or down should cause the pattern to scroll accordingly.

Press the Warrior Magic button to obtain the next screen.

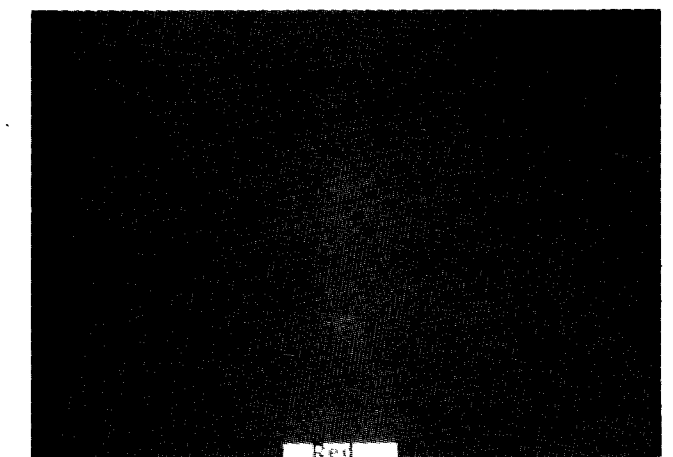

Figure 3-12 Color Purity Test

Coin Controls, Inc. Coin Door Assembly Parts List

| Part No. | Description |
|------------|--|
| A036597-01 | Harness Assembly (Ireland-Built cabinet only) |
| A037542-01 | Harness Assembly |
| 72-1414S | #4-40 × 7/8-Inch Cross-Recessed Pan-Head Steel Machine Screw |
| 75-056 | #6 Internal-Tooth Zinc-Plated Steel Lock Washer |
| 75-914S | #4-40 Steel Machine Hex Nut |
| 75-3414S | #4-40 × 7/8-Inch 82° Cross-Recessed Flat-Head Steel Machine Screw |
| 99-15001 | Coin Return Button with U.S. 25-cent Price Plate |
| 99-15002 | Coin Return Button with U.S. \$1 Price Plate |
| 99-15003 | Coin Return Button with German 1 DM Price Plate |
| 99-15004 | Coin Return Button with German 2 DM Price Plate |
| 99-15005 | Coin Return Button with German 5 DM Price Plate |
| 99-15006 | Coin Return Button with Belgian 5 Fr Price Plate |
| 99-15007 | Coin Return Button with French 1 Fr Price Plate |
| 99-15008 | Coin Return Button with Japanese 100 Yen Price Plate |
| 99-15009 | Coin Return Button with British 10 Pence Price Plate |
| 99-15010 | Coin Return Button with Australian 20-cent Price Plate |
| 99-15011 | Coin Return Button with Italian 100 Lire Price Plate |
| 99-15025 | Left Half of Coin Inlet |
| 99-15026 | Right Half of Coin Inlet |
| 99-15027 | Side Plate of Coin Return Box |
| 99-15028 | Base Plate of Coin Return Box |
| 99-15029 | Switch Bracket |
| 99-15036 | Metal Coin Return Cover |
| 99-15038 | Bezel for Coin Return Button |
| 99-15039 | Metal Bezel for Coin Return Button |
| 99-15042 | Coin Switch for U.S. 25 cents |
| 99-15052 | Spring for Coin Return Button |
| 99-15055 | Retaining Screw |
| 99-15056 | #4-40 × 5/16-Inch Cross-Recessed Pan-Head Steel Machine Screw |
| 99-15060 | Switch Cover |
| 99-15063 | Screw for Hinge |
| 99-15066 | Screw for Clamp |
| 99-15067 | Lock Assembly |
| 99-15070 | Doors and Frame |
| 99-15071 | Clamp for Frame |
| 99-15072 | Door Frame |
| 99-15073 | Upper Door |
| 99-15074 | Lower Door |
| 99-15075 | Switch Adjuster |
| 99-15083 | Base Plate—includes: |
| 99-15040 | Lever |
| 99-15054 | Pivot for Lever |
| 038091-01 | Coin Box—not included in assembly (Acceptable substitute is part no. A037491-01) |
| 170000-001 | 6.3 V Miniature Wedge-Base Incandescent Lamp |
| 171006-035 | Metal Coin Mechanism |
| 171050-001 | Dual Entry Face Plate |
| 179047-001 | Lamp Base |

Maintenance

This chapter includes preventive and corrective maintenance procedures for the Gauntlet game components that are subject to the most use. To assure maximum trouble-free operation from this game, we recommend that preventive maintenance be performed as described in this chapter.

Removal, disassembly, reassembly, and replacement procedures are provided for components that may require corrective maintenance. Appropriate references are provided to Chapter 5 Illustrated Parts Lists, to aid in locating the parts of this game that are mentioned, but not illustrated, in the maintenance procedures.

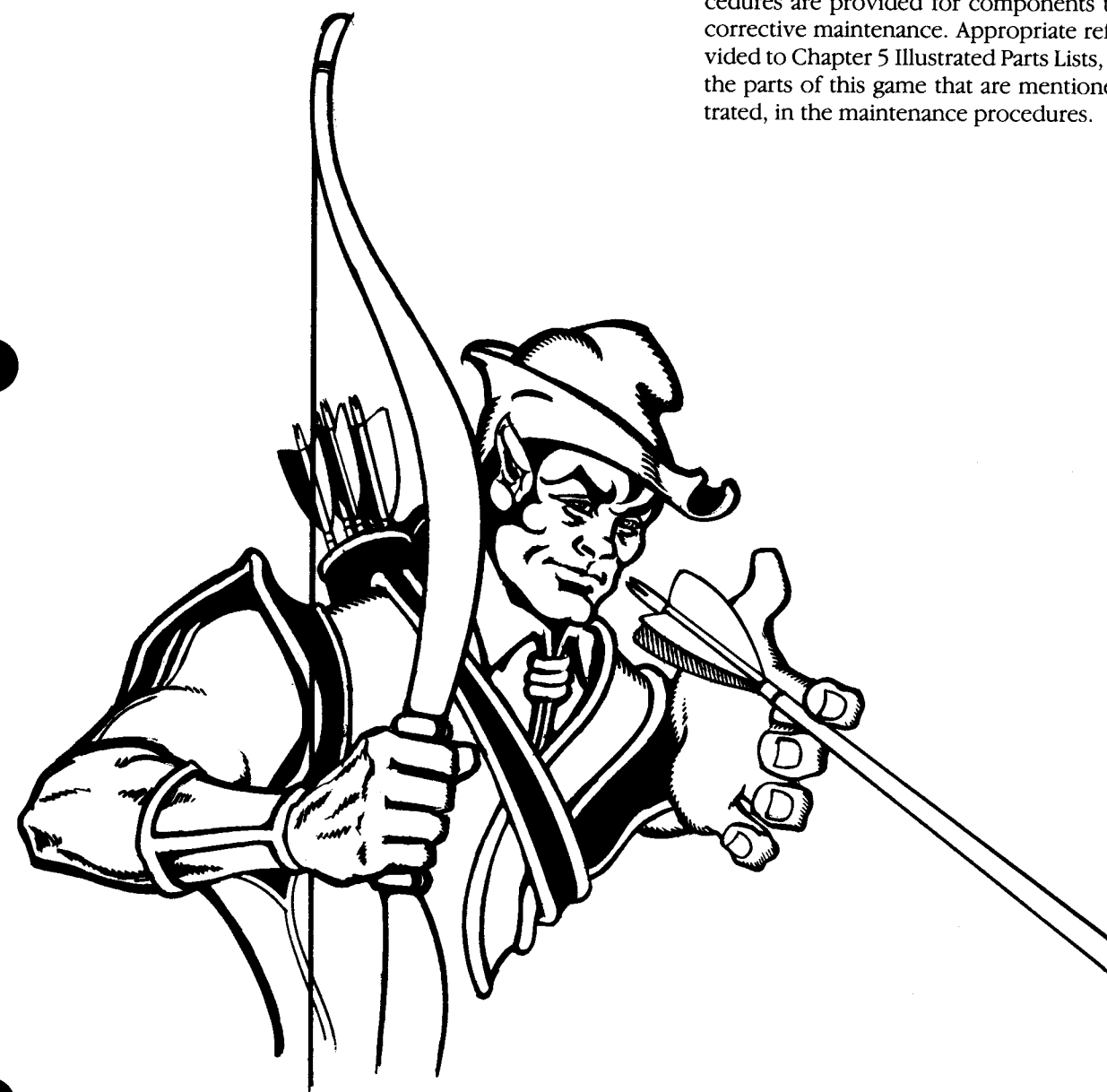

Chapter 4

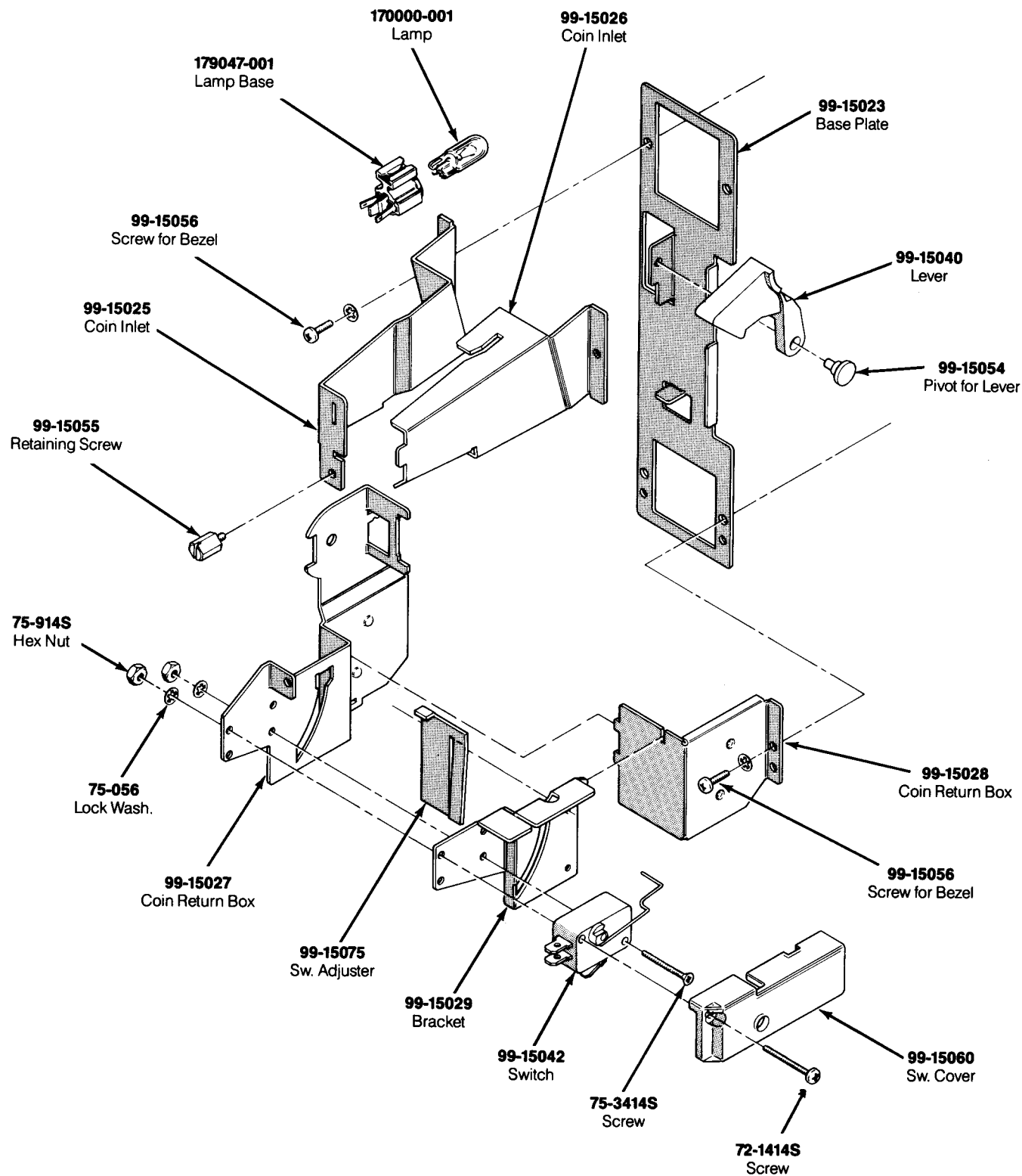

**Figure 5-6 Coin Controls, Inc. Coin Door Assembly
171034-xxx A**

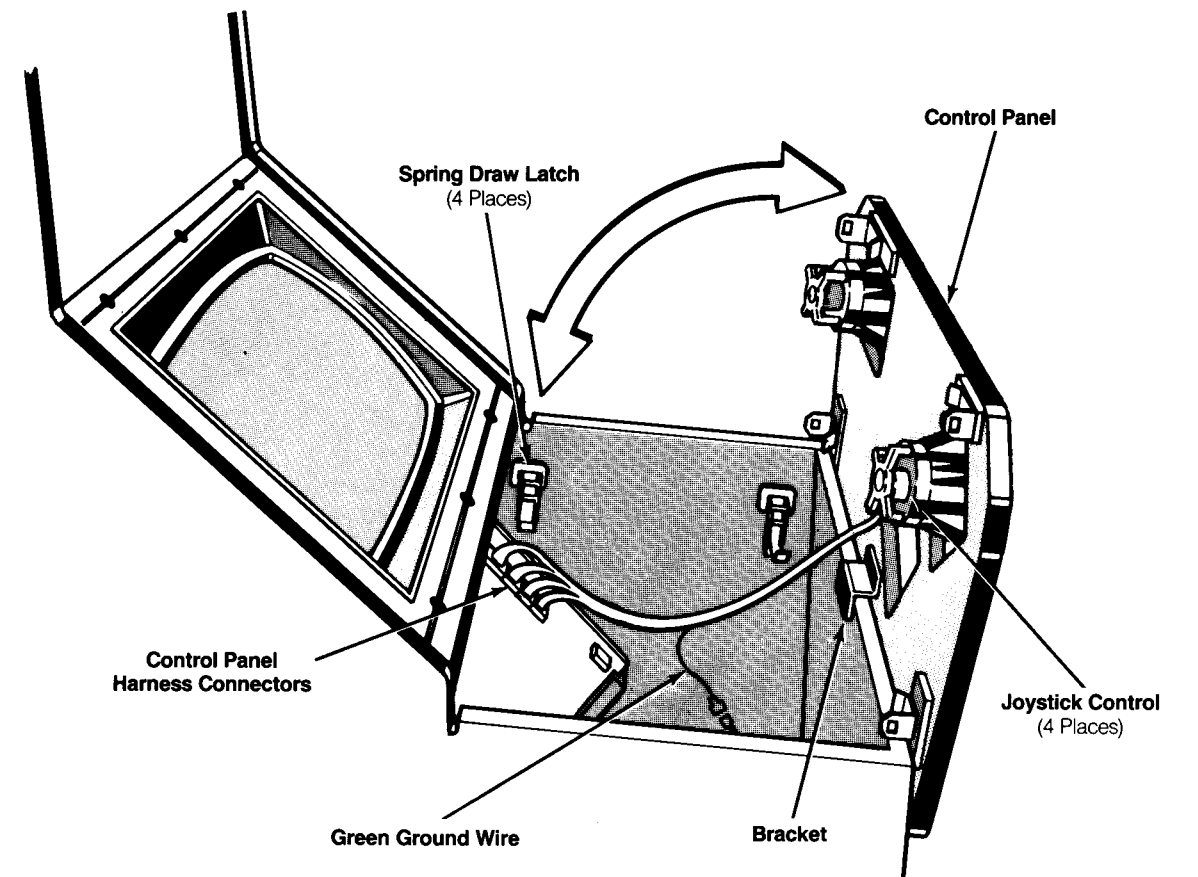

Figure 4-1 Control Panel Removal

CAUTION

Be extremely careful when cleaning the electrical components inside the cabinet. Avoid touching the electrical components with any solid object other than the soft bristles of the vacuum attachment or paint brush.

Joystick Controls

Preventive maintenance on the joystick control consists of inspecting the pivot and actuator balls for excessive wear or dirt, lubricating the pivot ball, adjusting the leaf switches and, if necessary, replacing or tightening the securing hardware.

Lubricating the Joystick Controls

Perform the following procedure to lubricate and tighten the joystick controls (see Figure 4-2).

1. Remove the control panel as previously described.
2. Apply a light film of Lithium grease (Atari part no. 107027-001) to the lubrication points shown in Figure 4-2.
3. Using a 3/8-inch wrench, tighten the four nuts holding the joystick to the control panel.
4. Using a 1/4-inch wrench (or an appropriate tool), tighten the four screws holding the positioning plate to the lower housing.

Corrective Maintenance

Corrective maintenance consists of removing, disassembling, reassembling, and replacing the pushbutton leaf

switches, joystick controls, game printed circuit board (PCB), video display, and speakers.



WARNING
Fuse cover must be in place during game operation.

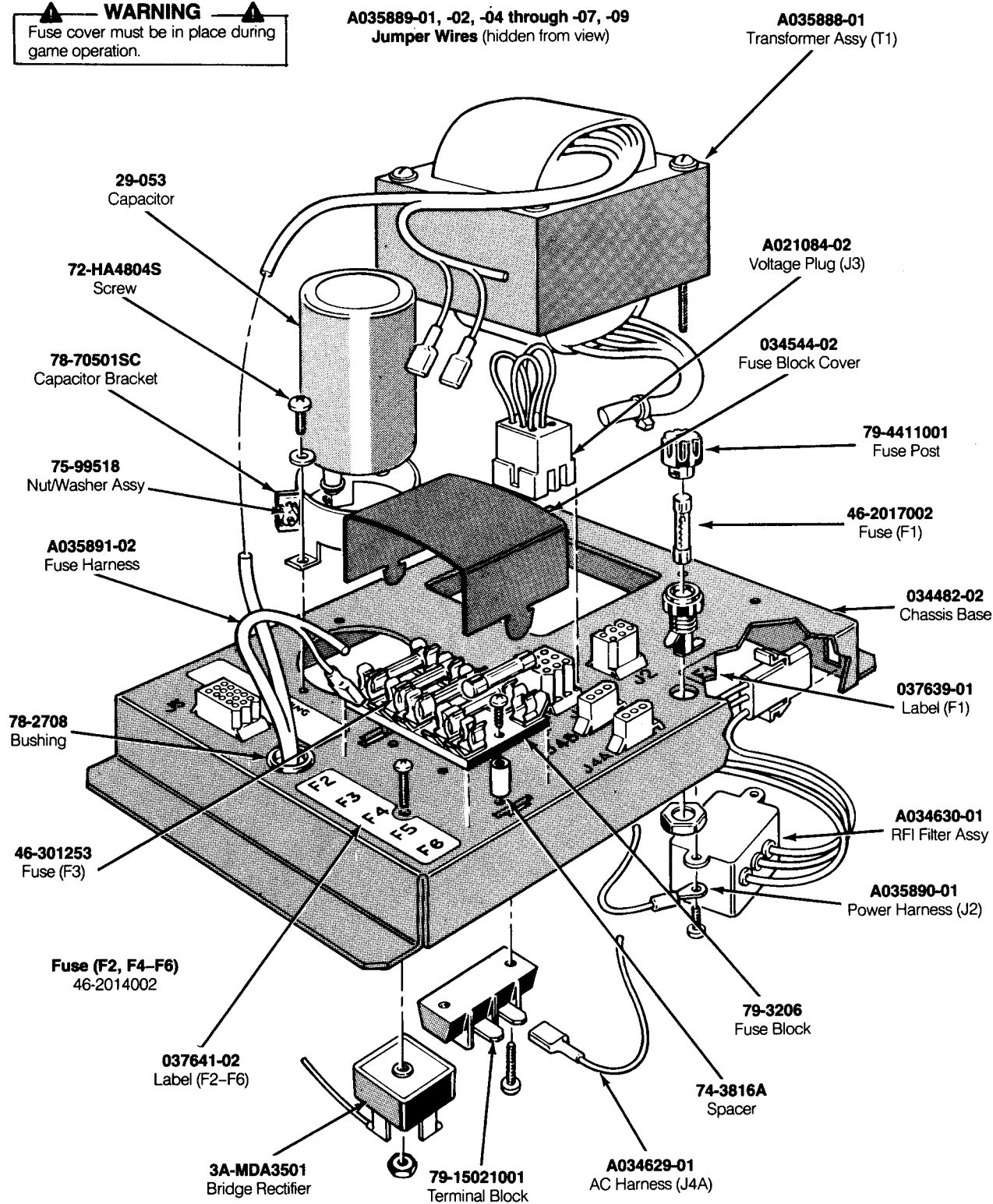

**Figure 5-5 Linear Power Supply Assembly
A037671-18 N**

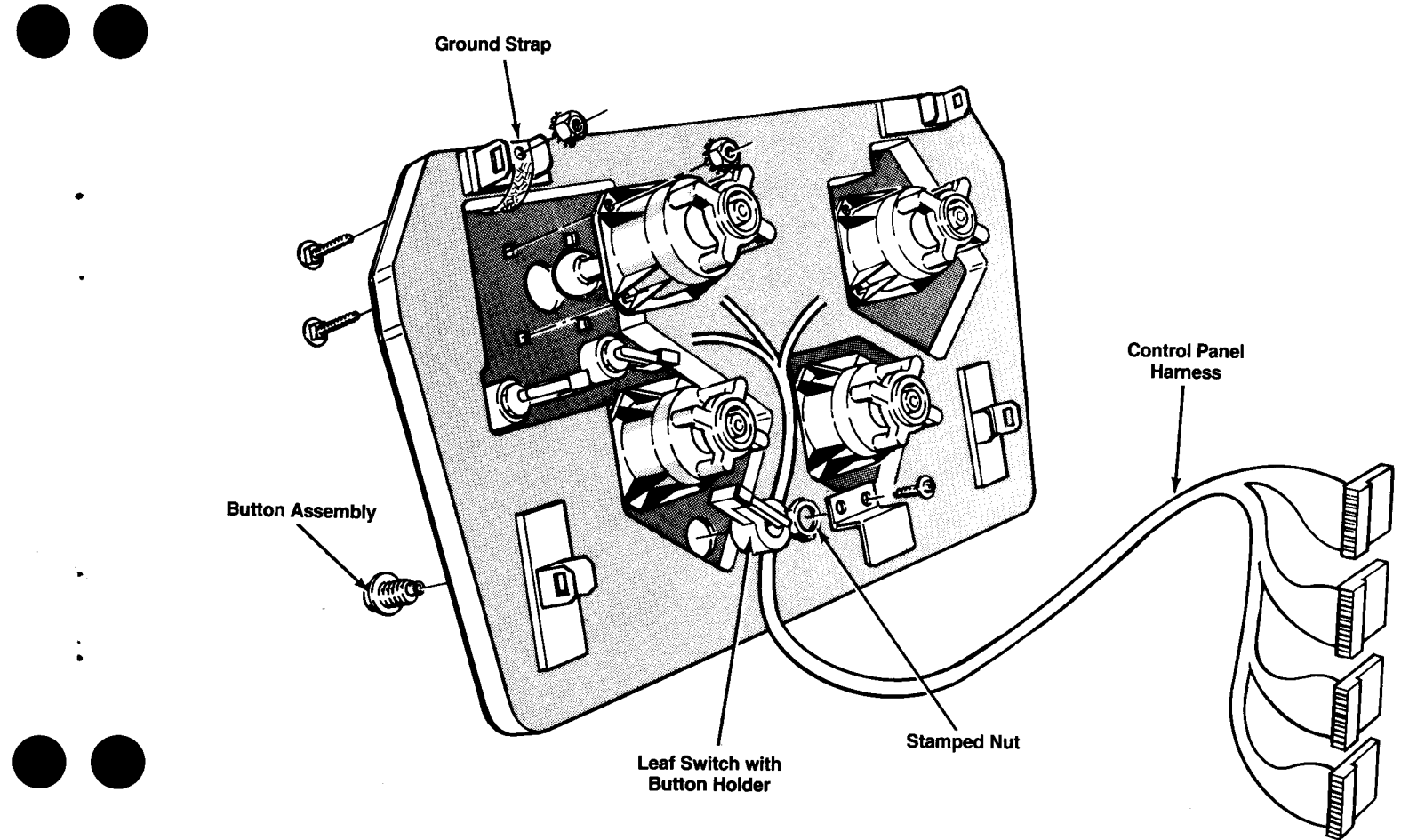

Figure 4-3 Pushbutton Leaf Switch Removal

Removing the Joystick Leaf Switches

Perform the following procedure to remove the leaf switches from the joystick (see Figure 4-2).

NOTE
You do *not* need to disassemble or remove the joystick from the control panel to remove the leaf switches.

1. Disconnect the two wires from the leaf switch.
2. Using a 5/64-inch hex wrench, remove the screw holding the leaf switch to the lower housing.
3. Replace the switch in reverse order of removal. Be sure to align the small extrusion on the bottom of the switch with the small hole nearest the screw casing on the bottom of the lower housing.
4. If required, adjust the switch to a narrow gap (about 1/16 inch).

5. Reconnect the harness wires as shown in the Game Wiring Diagram in the *Schematic Package Supplement* (SP-284).

Removing the Game PCB

Perform the following procedure to remove/replace the game PCB (see Figure 4-4).

1. Turn the game power off.
2. Rest the control panel in the open position as described under *Preventive Maintenance*.
3. Disconnect the eight harness connectors from the game PCB.
4. Using a Phillips screwdriver, remove the mounting screw and washers from the top front corner of the game PCB.
5. Grasp the front edge of the game PCB and gently slide it straight forward until it just clears the rear slotted guide.

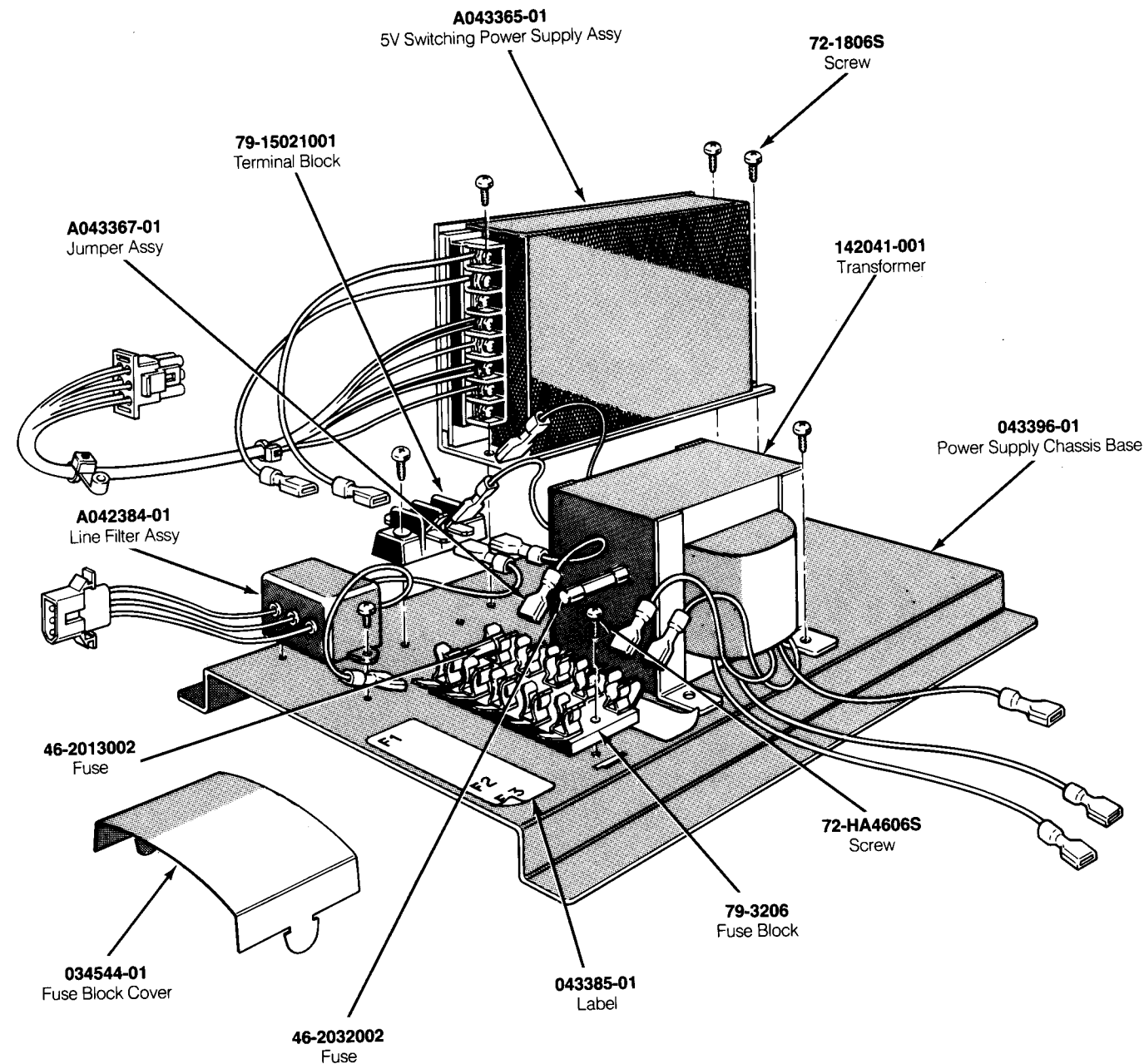

**Figure 5-4 Switching/Linear (SL) Power Supply Assembly
A043363-01 A**

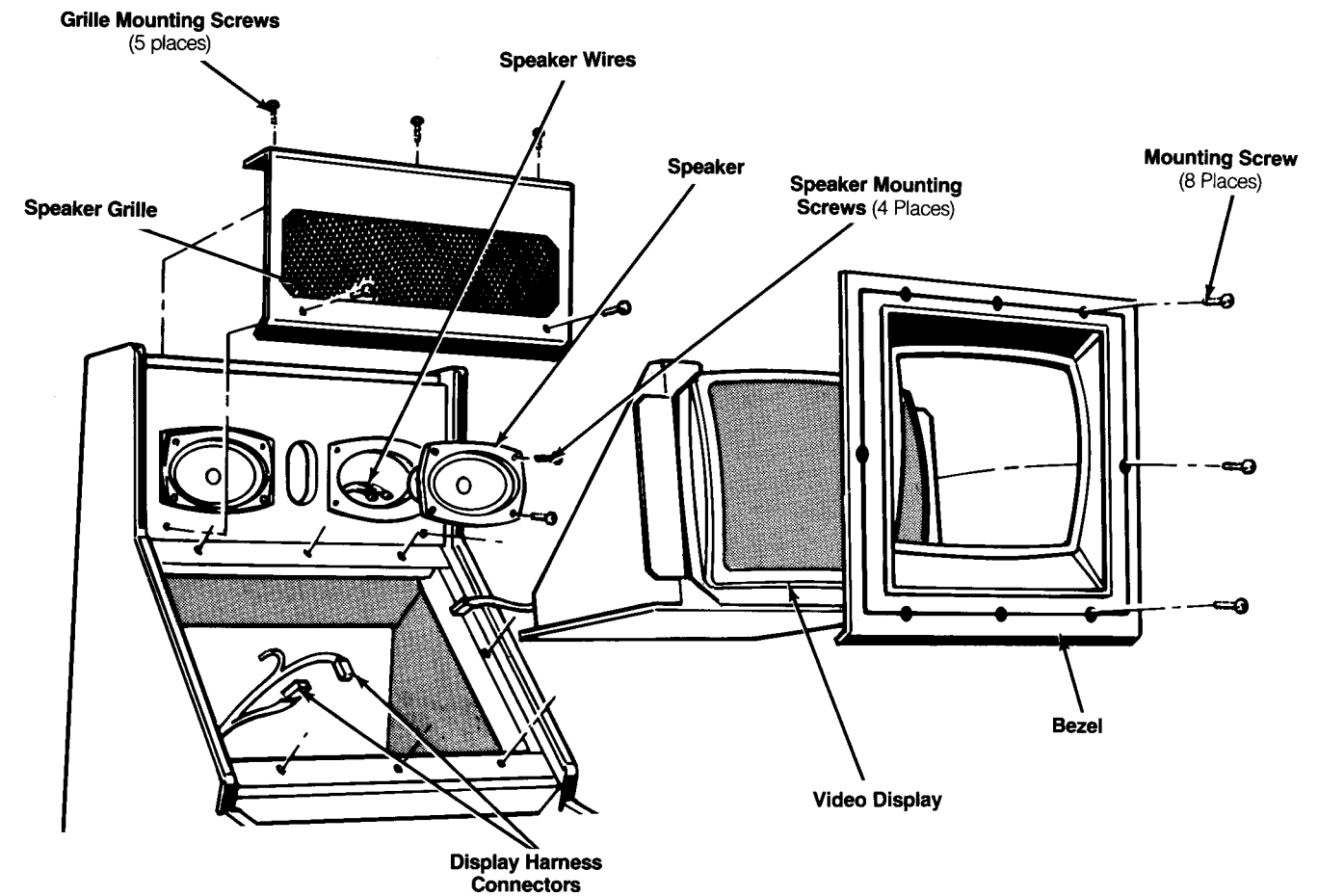

Figure 4-5 Video Display and Speaker Removal

- a. Attach one end of a large, well-insulated, 18-gauge jumper wire to ground.
- b. Momentarily touch the free end of the grounded jumper to the CRT anode by sliding it under the anode cap.
- c. Wait two minutes and repeat part b.
7. From the back of the cabinet, unplug the display harness connectors from the display.
9. Push the four carriage bolts up from the bottom of the shelf and remove them from the back of the cabinet.
10. Carefully slide the display out through the front of the cabinet.
11. Replace the video display as described in the following procedure.

⚠ WARNING ⚠

To avoid dropping the video display, use extreme care when removing the display from the cabinet. We recommend that a second person *carefully* hold the display chassis from the back of the cabinet while the other person lifts it from the front of the cabinet.

NOTE

Whenever the cathode-ray tube is replaced, readjust the brightness, size, centering, purity, and convergence as described in the display manual.

Replacing the Video Display

Perform the following procedure to replace the video display in the cabinet (see Figure 4-5). Note that *this procedure requires a second person* to help hold the display in position while the other person tightens the mounting nuts.

8. Using a 7/16-inch wrench, reach through the control panel opening and remove the four nuts and washers holding the video display to the cabinet shelf.

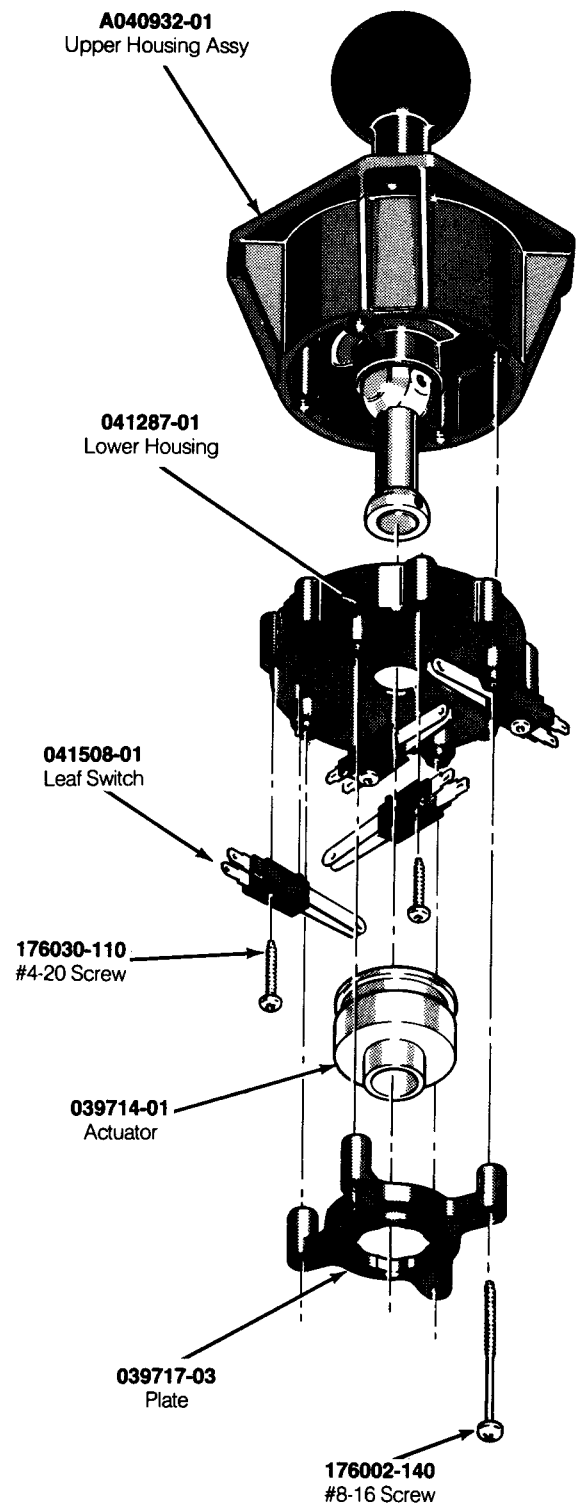

Figure 5-3 Joystick Assembly
A040934-03 B

Illustrated Parts Lists

This chapter provides information you need to order parts for your game. Common hardware (screws, nuts, washers, etc.) has been deleted from most of the parts lists.

The PCB parts lists are arranged in alphabetical order by component. Each component subsection is arranged alphanumerically by reference designator or location.

Other parts lists are arranged alphanumerically by Atari part number. In these parts lists, all A-prefix numbers come first. Following these are numbers in sequence evaluated up to the hyphen, namely 00- through 99-, then 000598- through approximately 201000-.

When ordering parts, please give the part number, part name, number of this manual, and serial number of your game. This will help us fill your order rapidly and correctly. We hope the results will be less downtime and more profit from your game.

Atari Customer Service numbers are listed on the inside front cover of this manual.

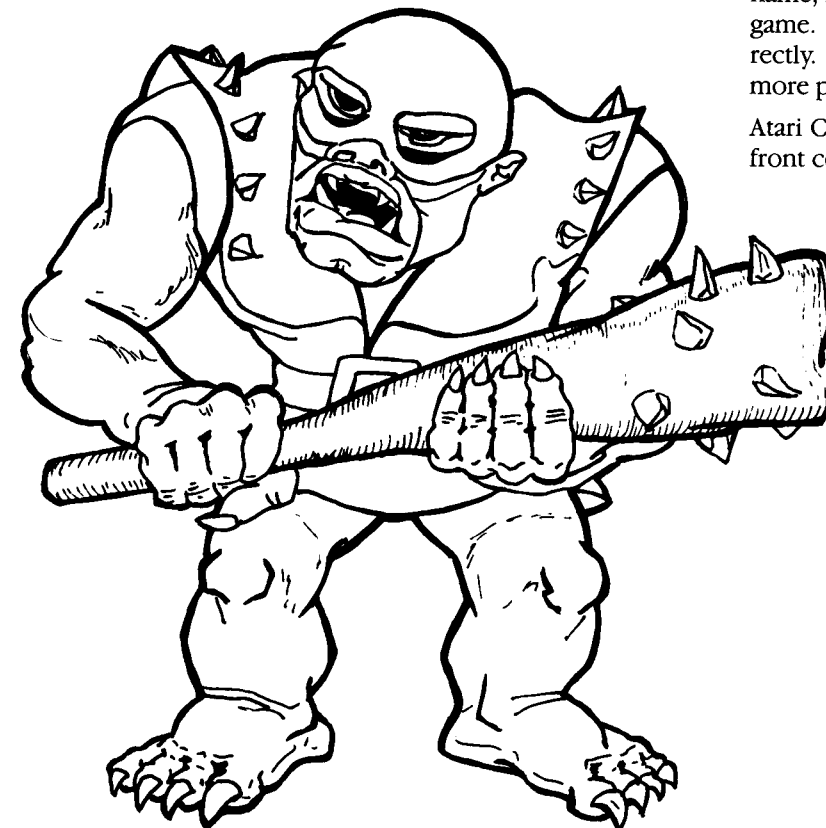

Chapter 5

NOTE
Be sure to use the proper type of leaf switch for the Fire and Magic/Start controls.

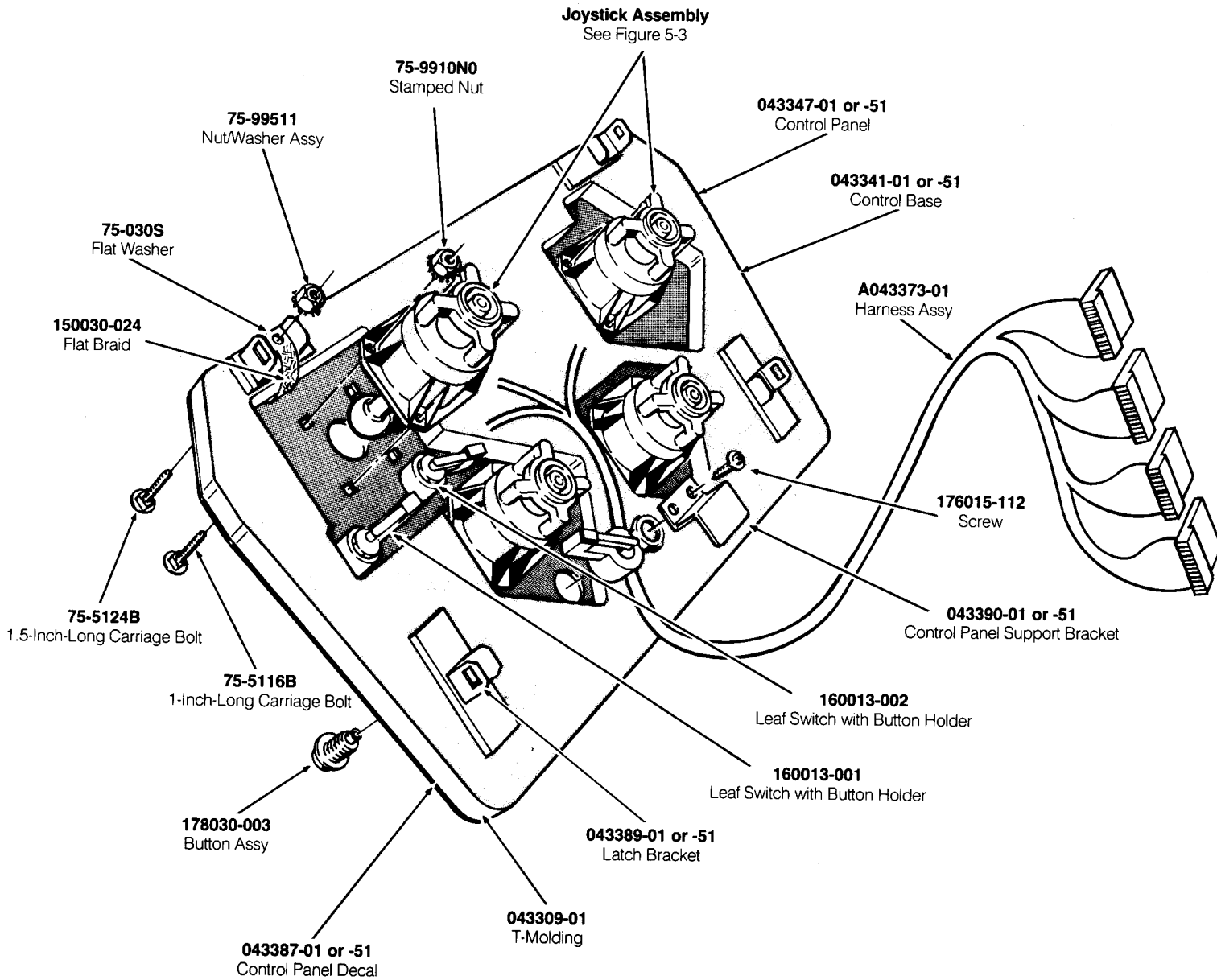

Figure 5-2 Control Panel Assembly
A043386-01 B (U.S.)
or A043386-51 B (Ireland)

★ Part used only in US-built cabinets
✿ Part used only in Ireland-built cabinets

Regulator Audio III PCB Assy
(Ireland only)
See Figure 5-10

A043379-01 ✿
Main Harness Assy

A040413-02 ✿
Utility Panel

A043036-51 ✿
PCB Power Harness Assy

043324-01 ★, or
043324-51 ✿
Upper Panel

A043371-01
Display Harness Assy

A043368-01 ★, or
A043380-01 ✿
Power Harness Assy

Power Supply Assy
(Ireland only)
See Figure 5-5

Power Supply Assy (US only)
See Figure 5-4

043323-01 ★, or
043323-51 ✿
Lower Panel

A043055-01 ★, or
A043055-04 ✿
On/Off Switch & Power Cord

A043003-01 ✿
Fan Assy
043349-51 ✿
Fan Grille

A043340-01 ★, or
A043340-51 ✿
Cabinet Assy

A043377-01 ★
Display Power Harness Assy

78-3201
Adjustable Glide

Figure 5-1 Cabinet-Mounted Assemblies, Continued